

# akotom®

**Konveyör Bant**  
Crop Conveyor Belts

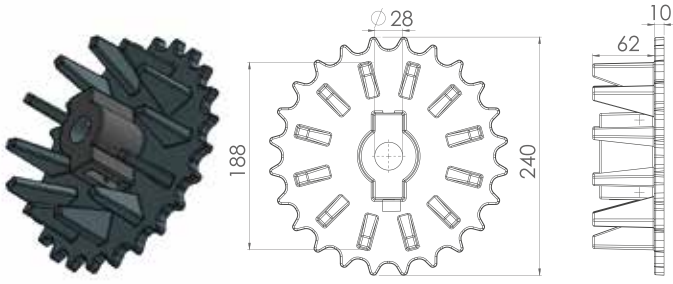

[www.akotom.com](http://www.akotom.com)



D800

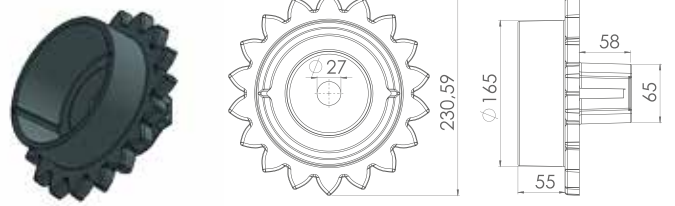

D801

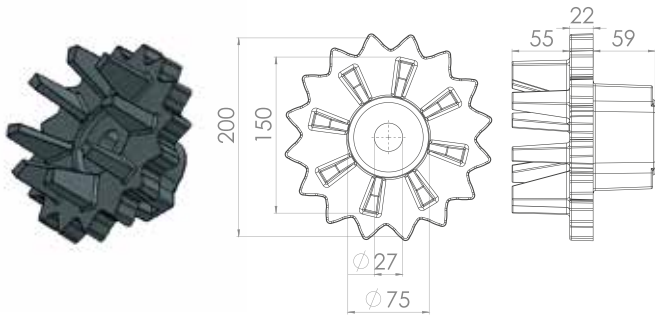

D802

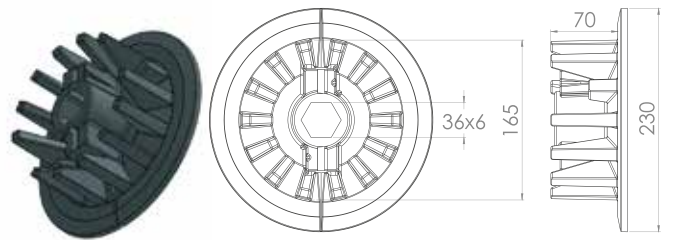

D803

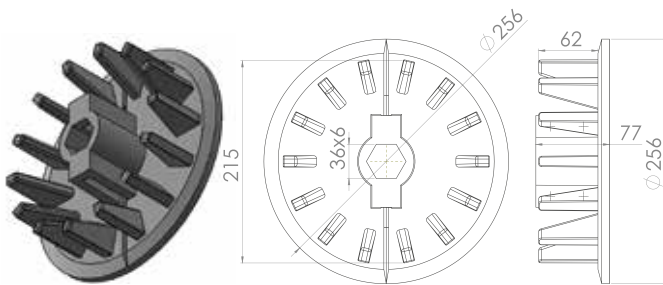

D804

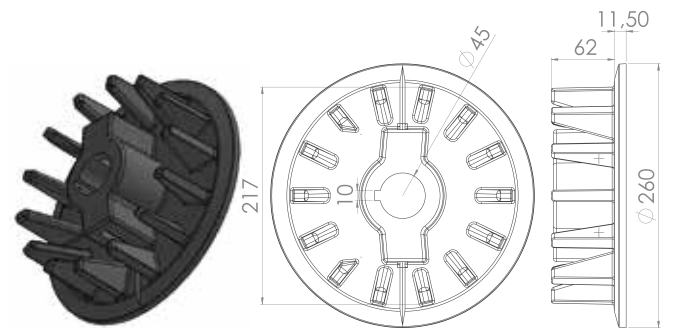

D805

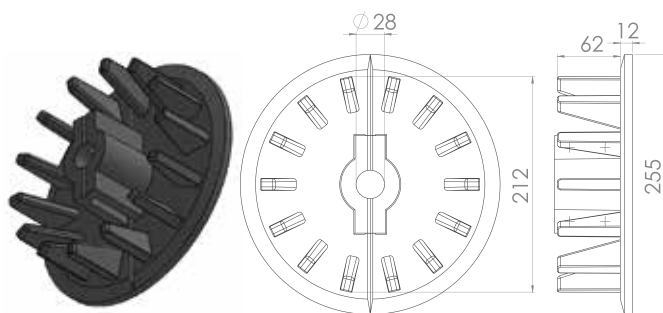

D806

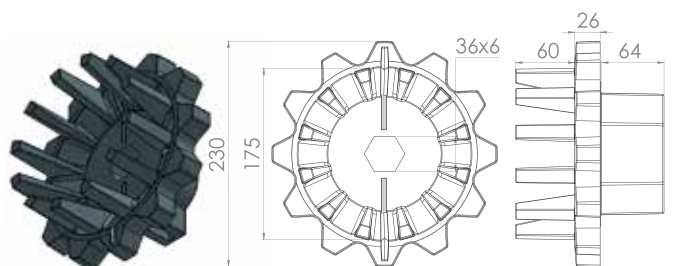

D807

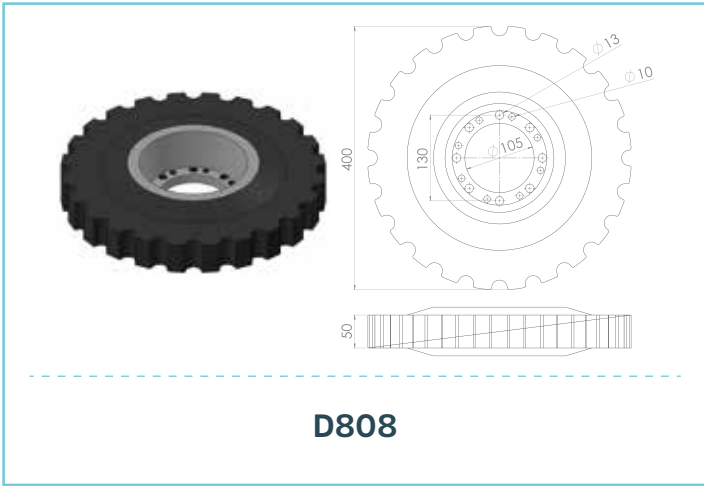

D808

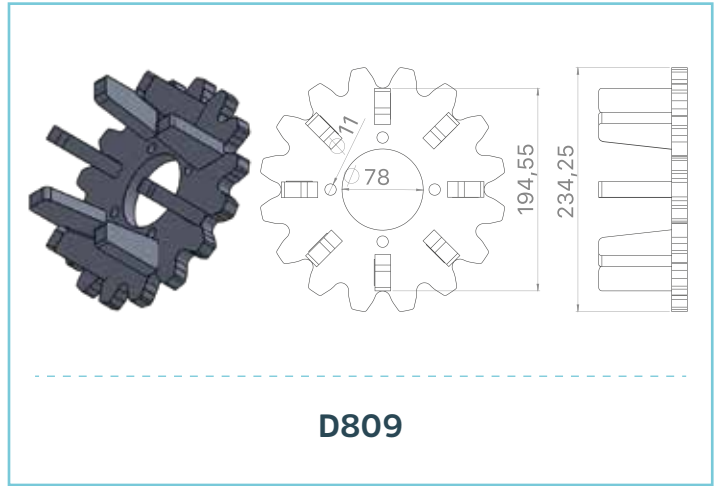

D809

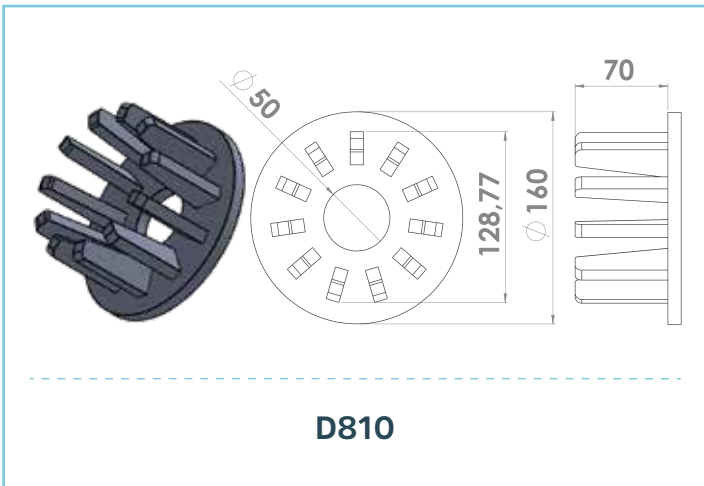

D810

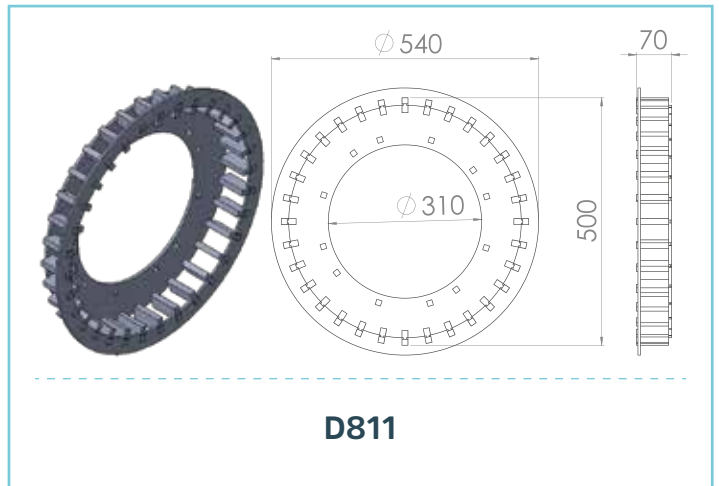

D811



D812



D813

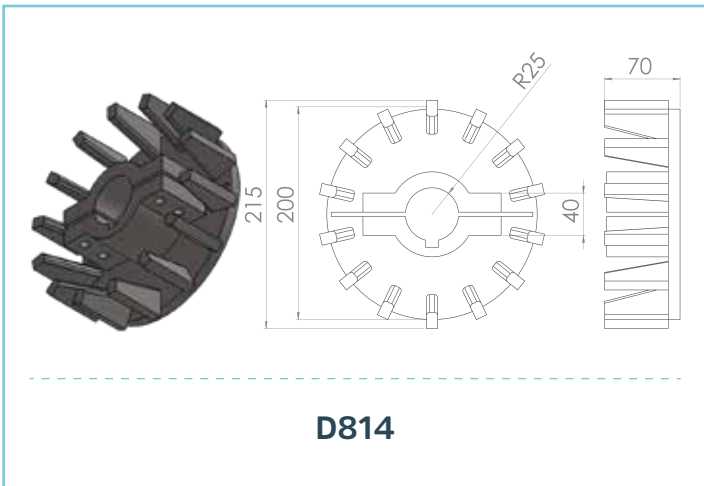

D814



D815

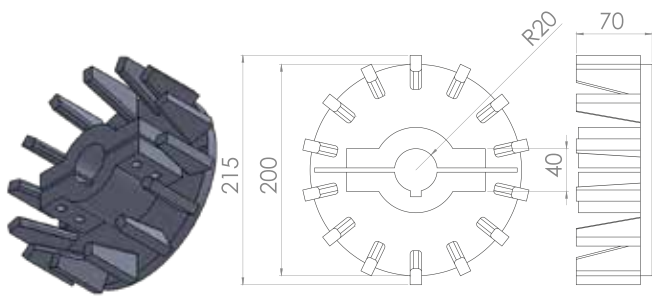

D816

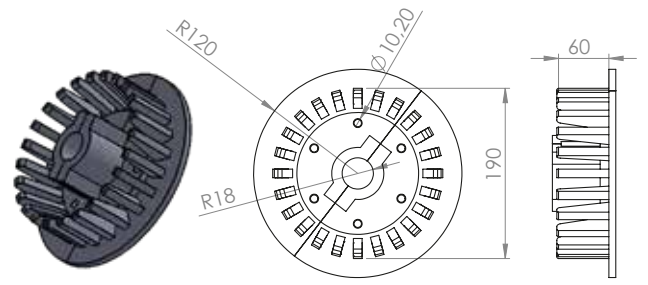

D817

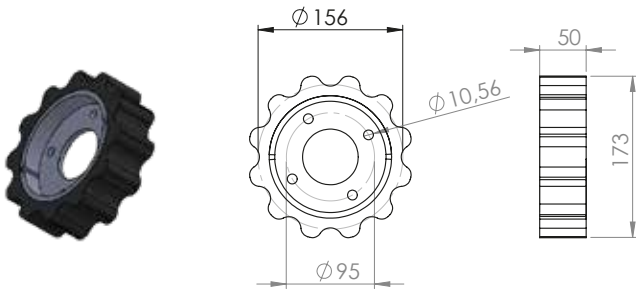

D818

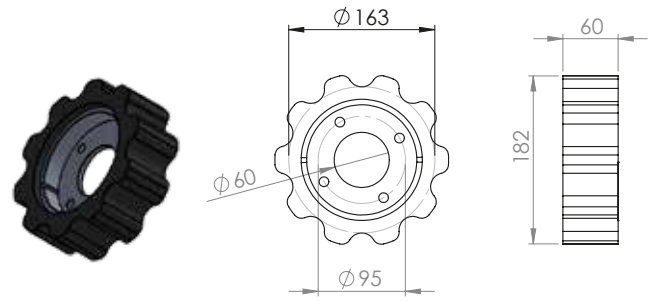

D819

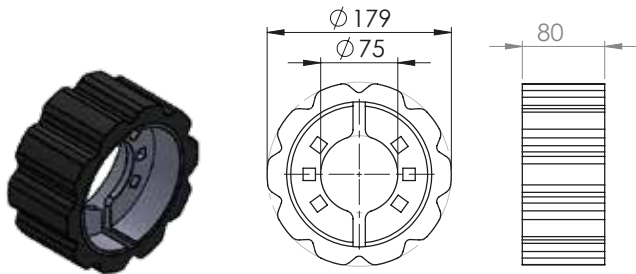

D820

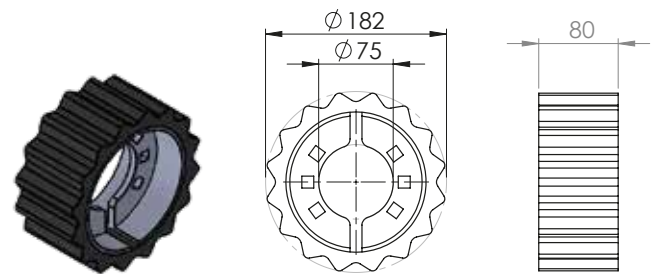

D821

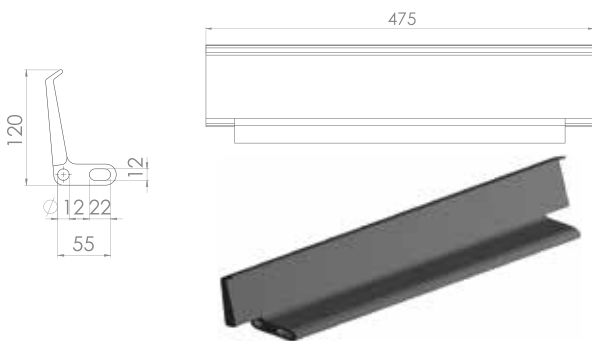

GT100

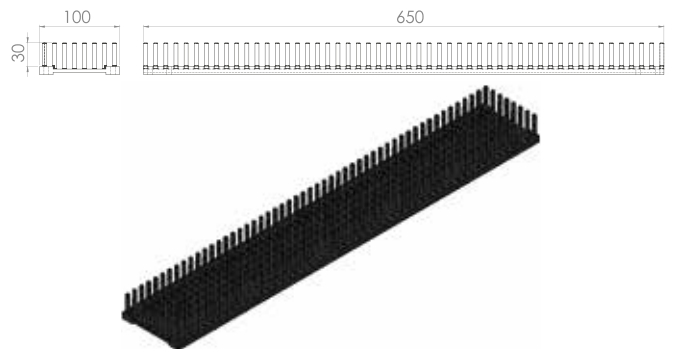

GT101

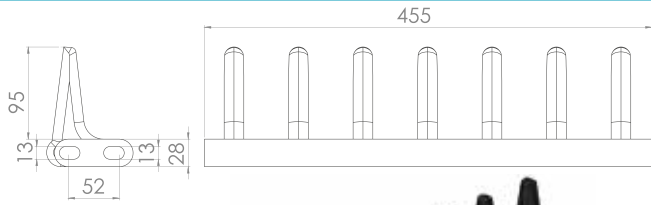

GT102



GT103



GT104

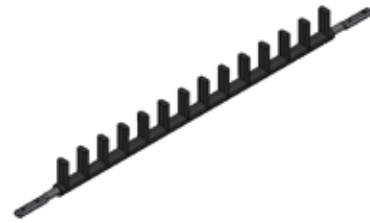
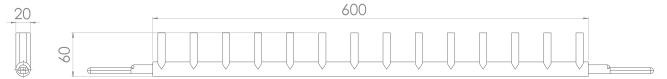

GT105

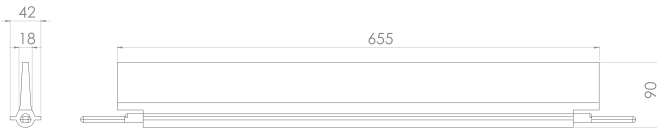

GT106



GT107



GT108



GT109

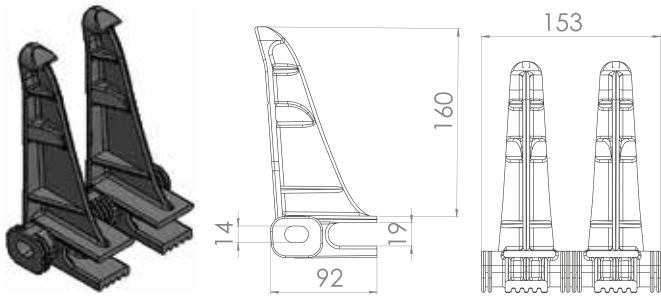

GT110

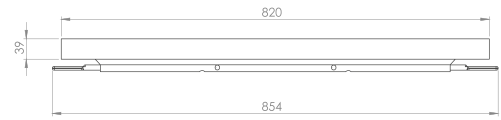

GT111

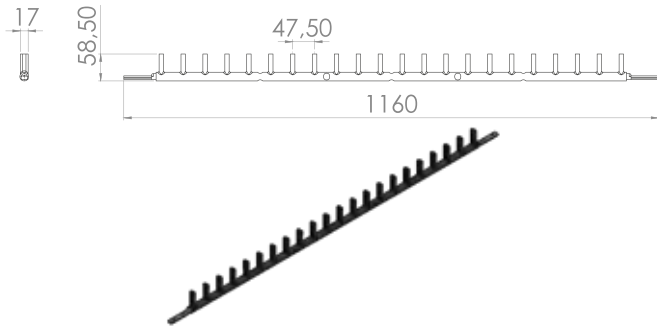

GT112

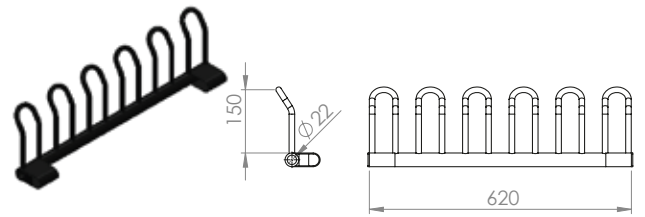

GT113

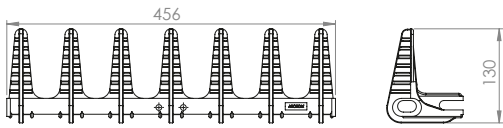

GT114

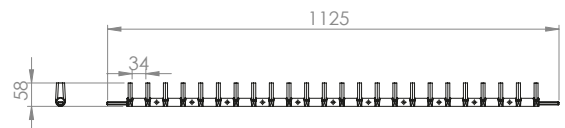

GT115

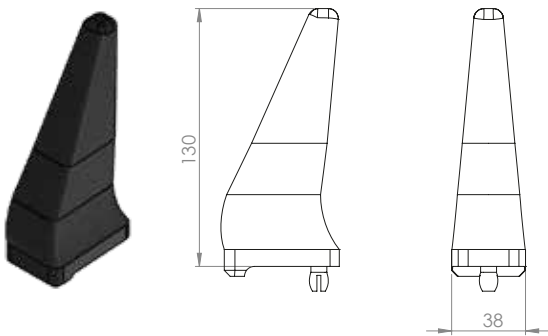

GT116

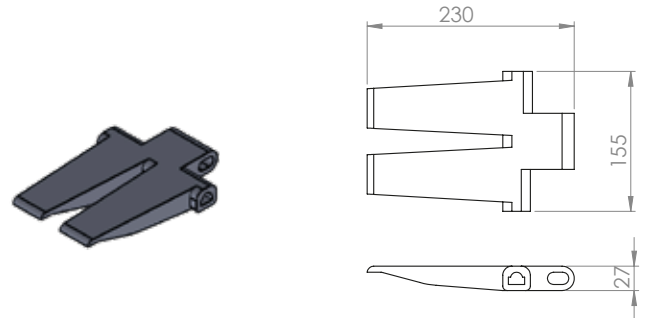

GT117

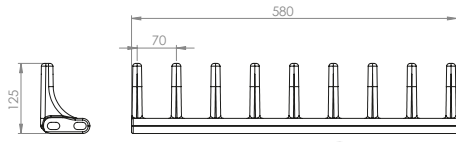

GT118

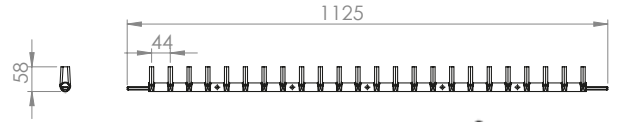

GT119

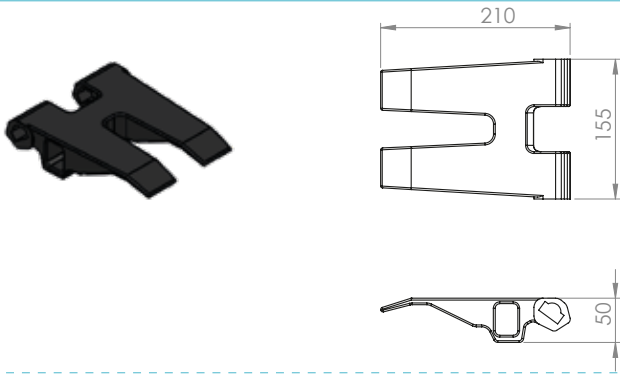

GT120



GT121

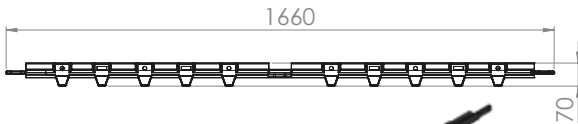

GT122



H500

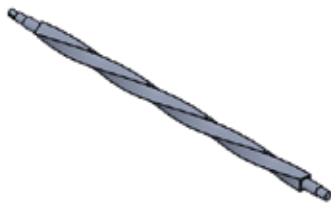
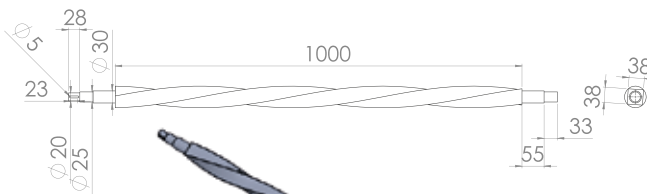

H501

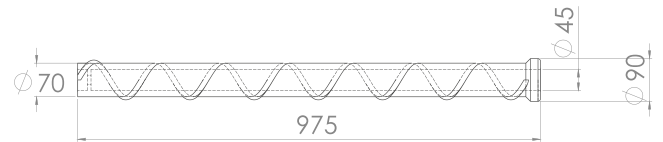

H502

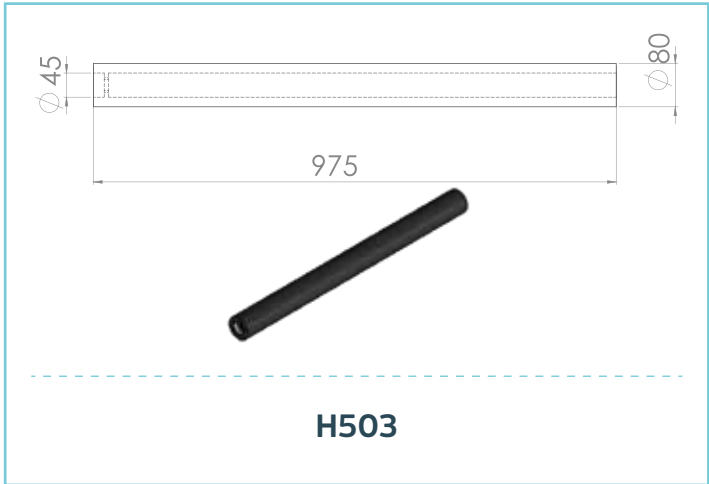

H503

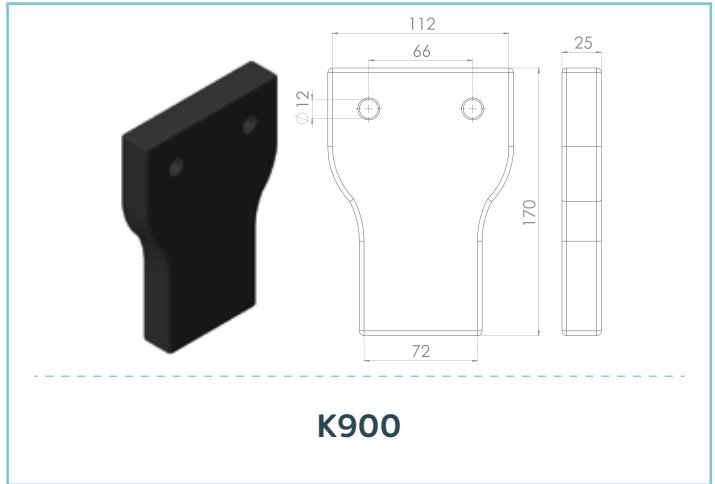

K900



K901



K902

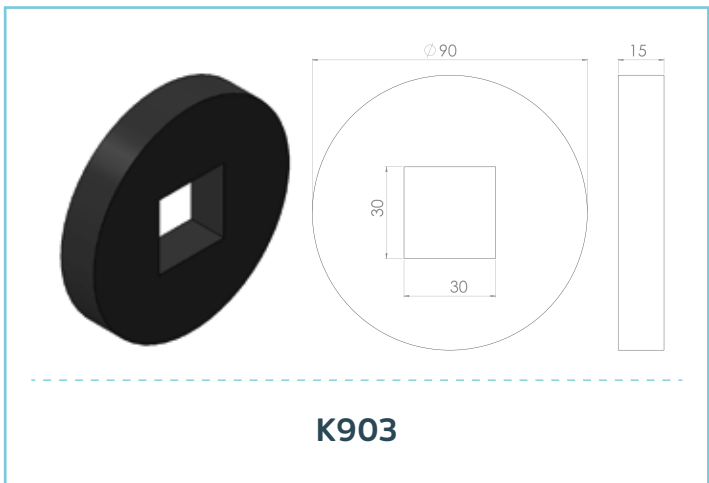

K903

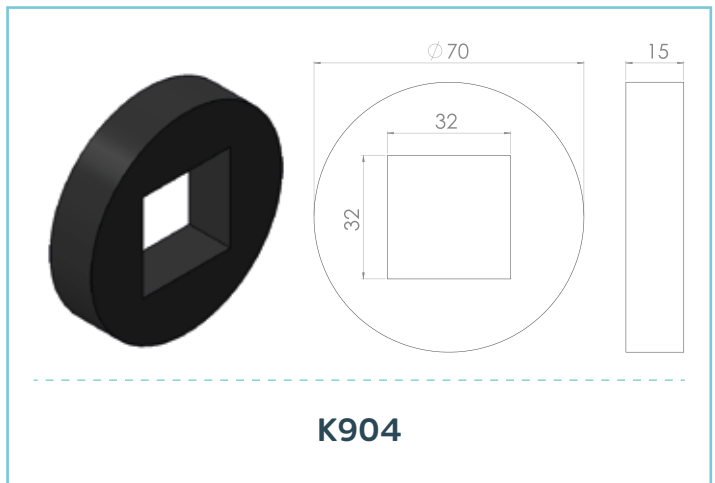

K904



K905



K906



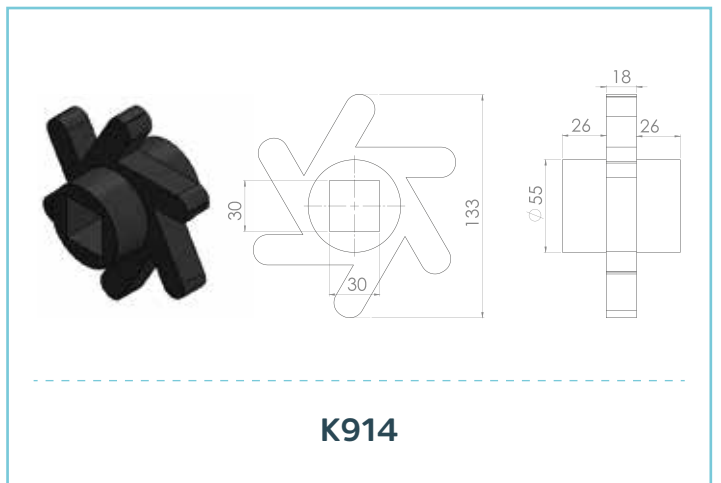
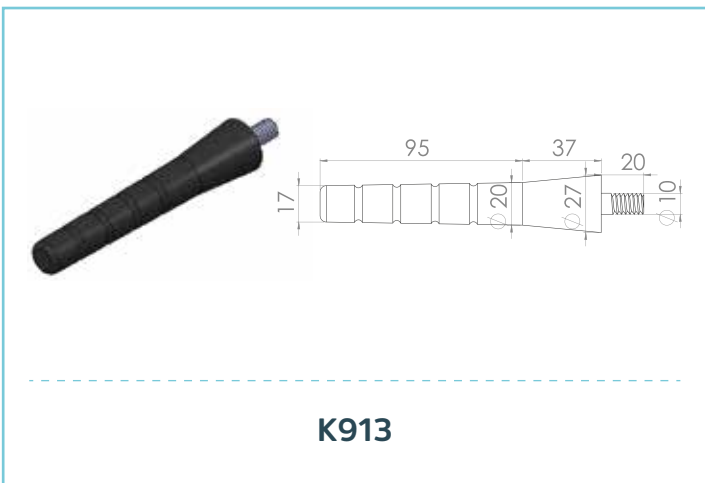
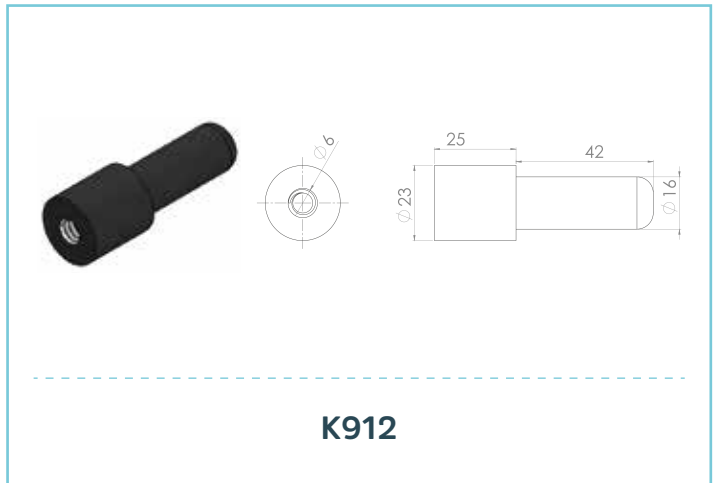
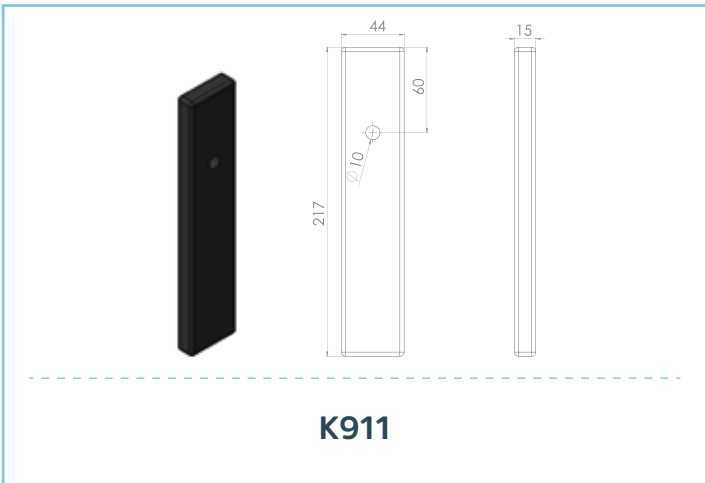
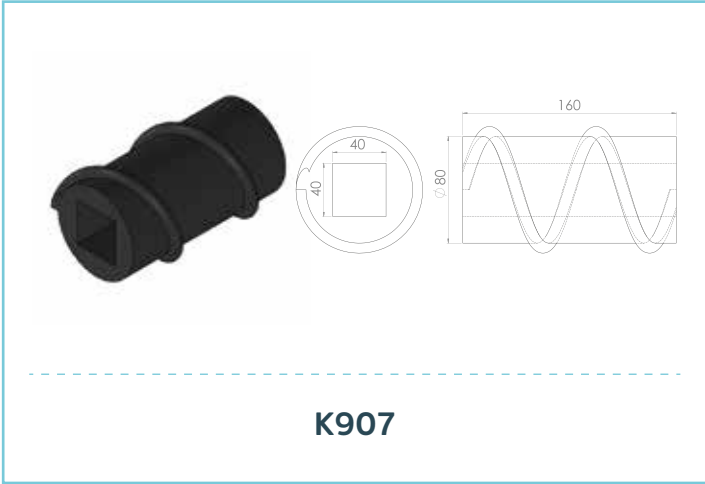

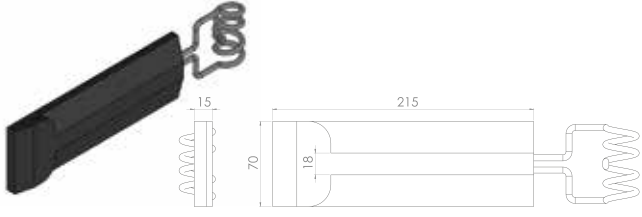

**K915**

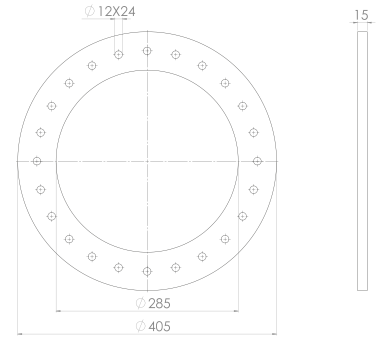

**K916**

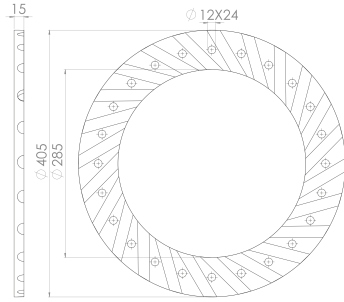

**K917**

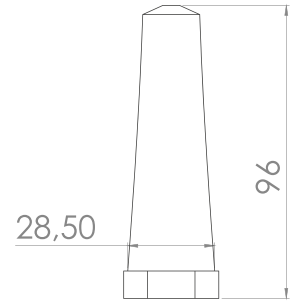

**K918**

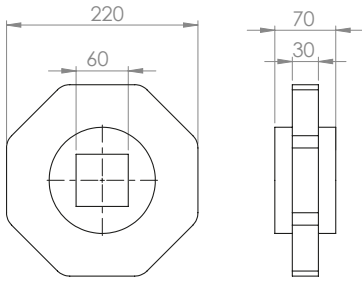

**K919**

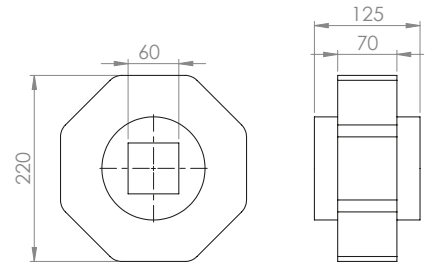

**K920**

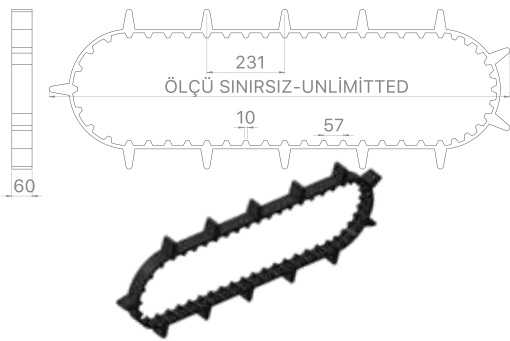

**K921**



**K922**

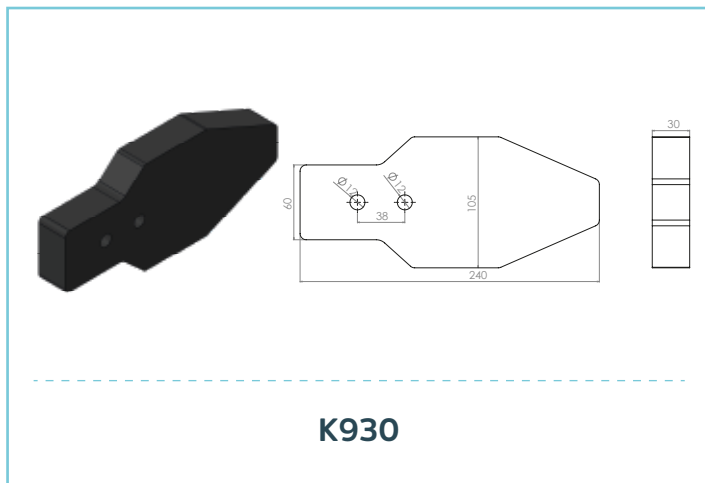
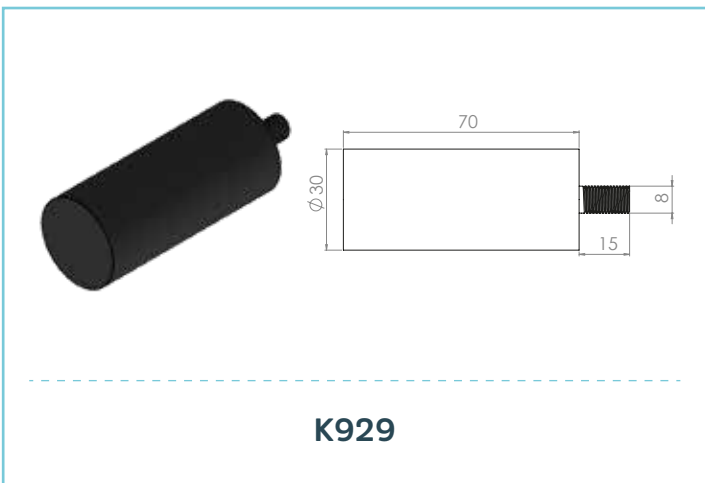
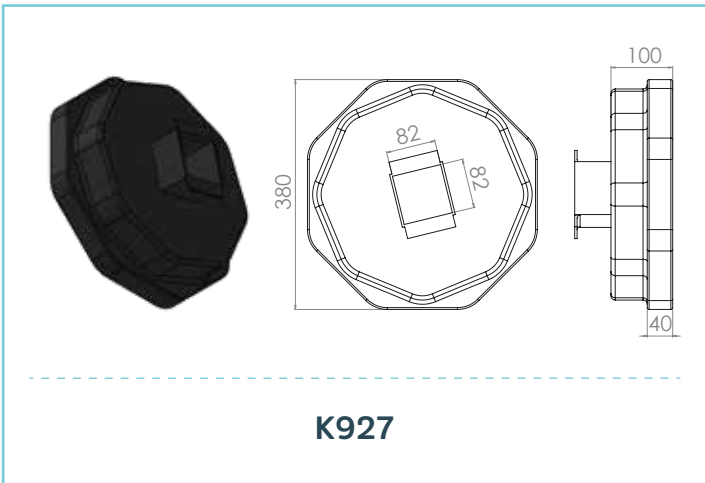
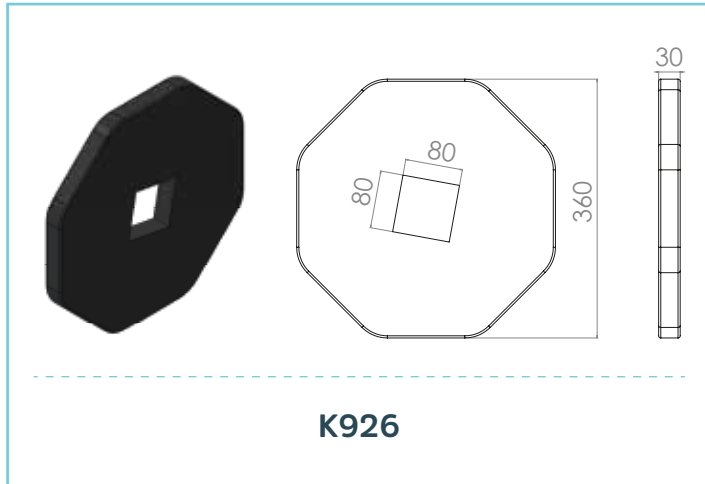
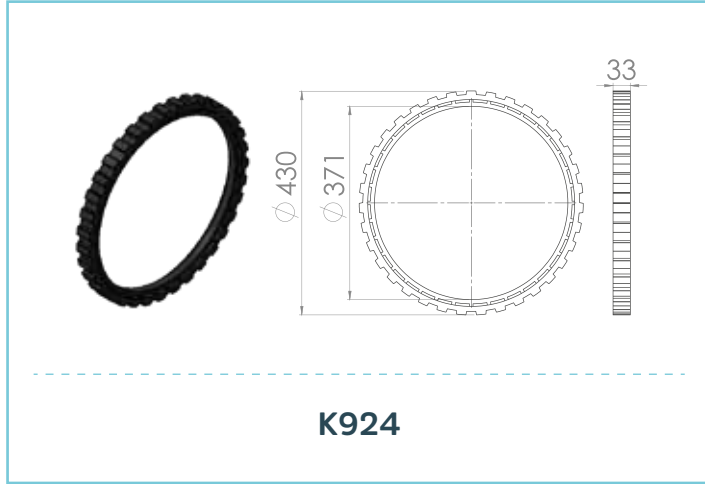

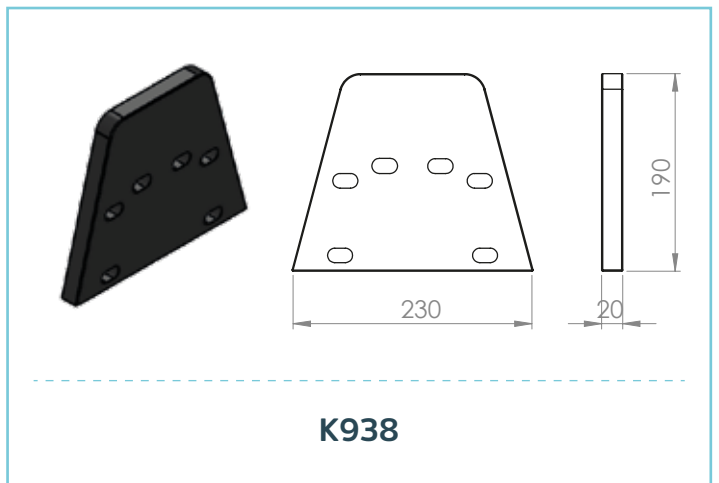
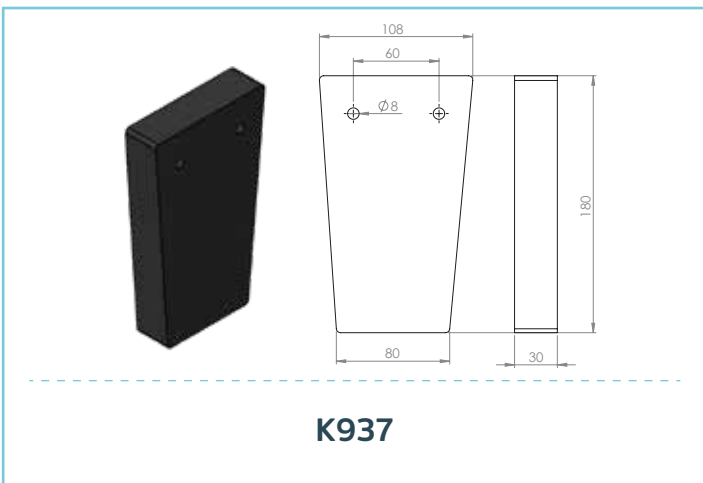
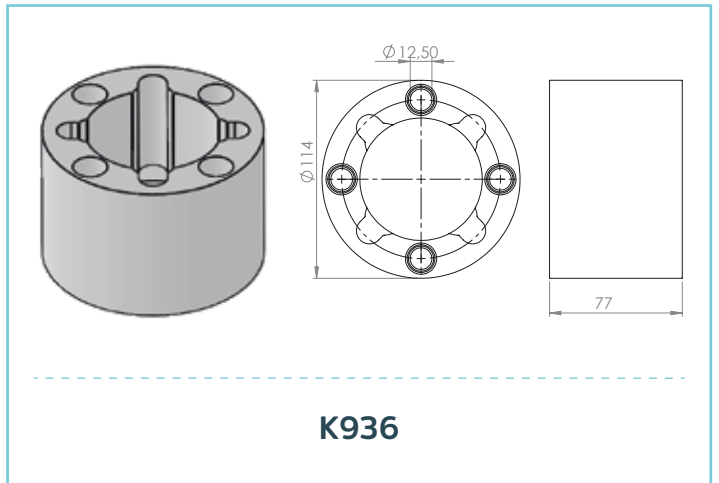
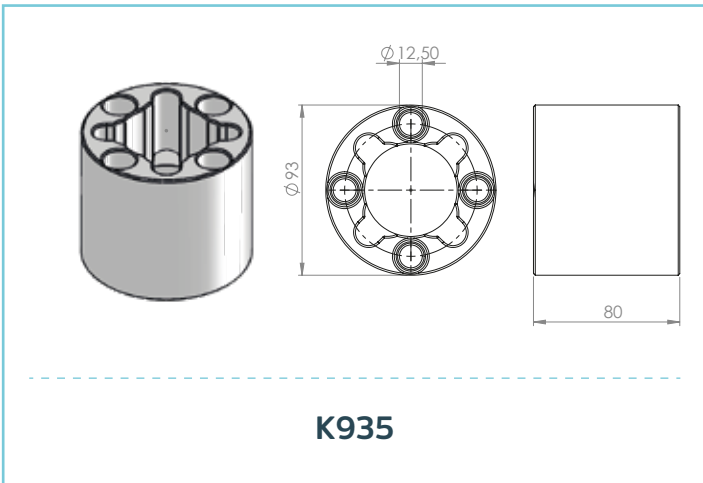
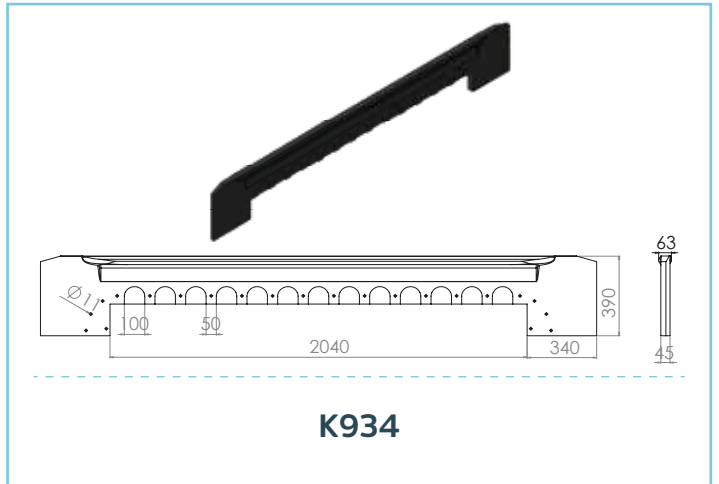
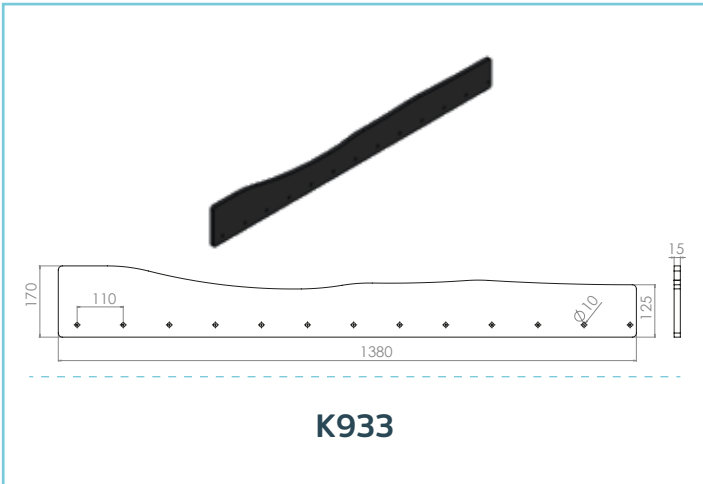
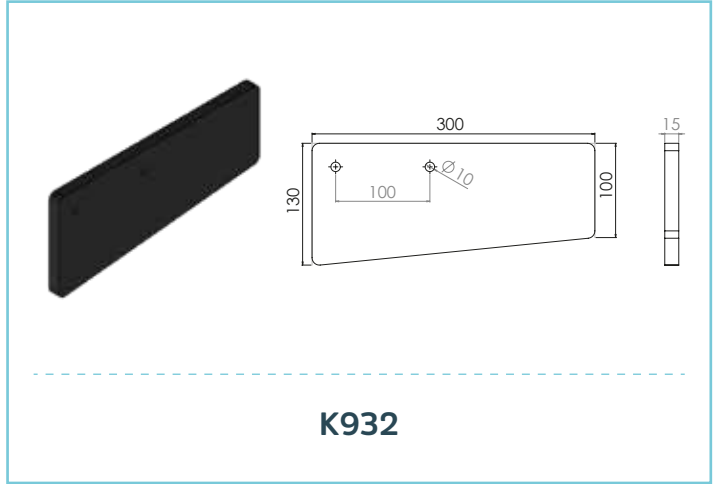
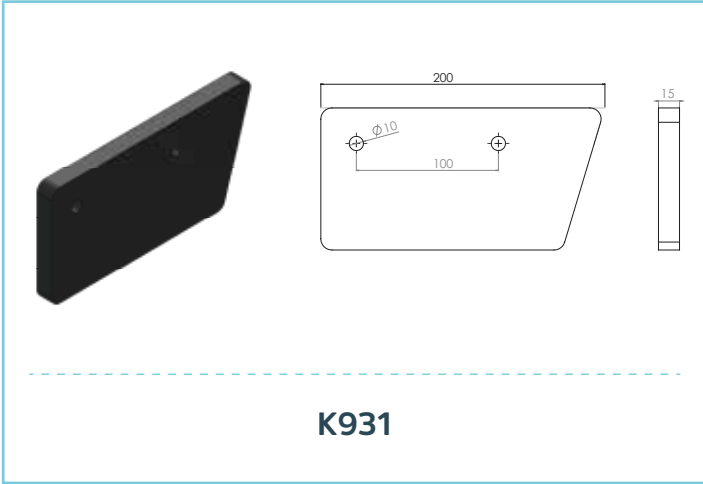

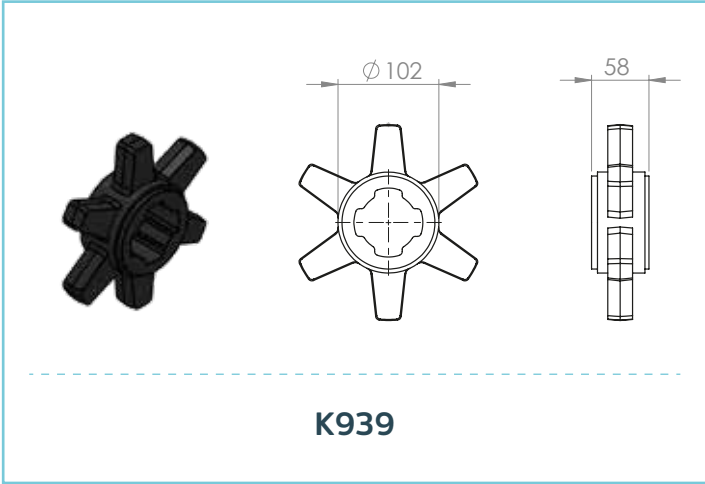

**K939**

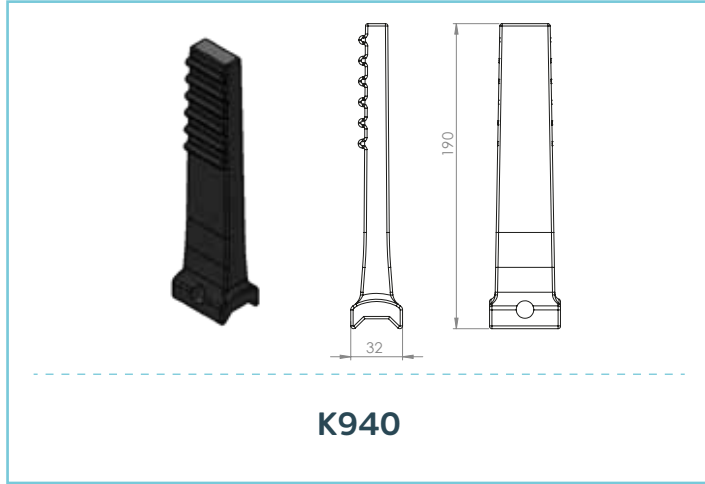

**K940**

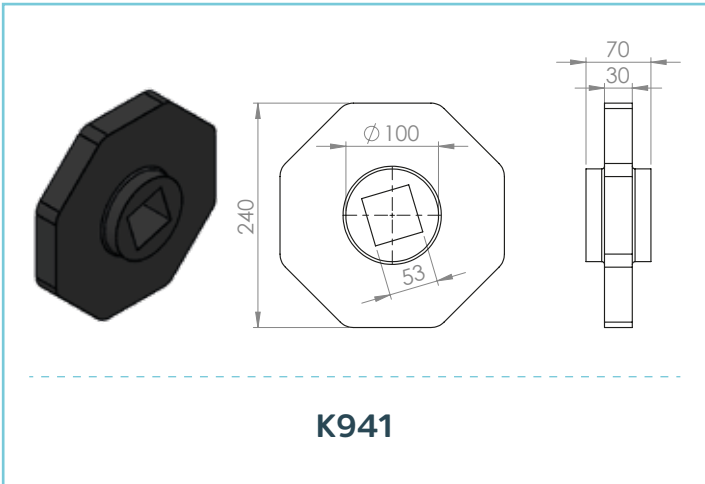

**K941**

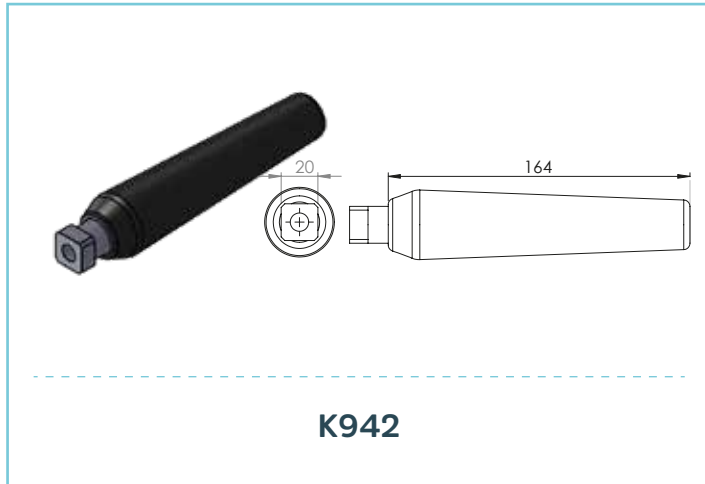

**K942**



**K943**

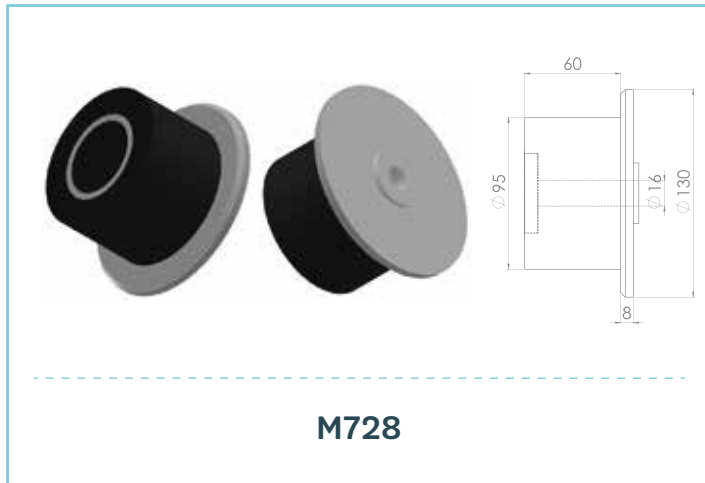

**M728**

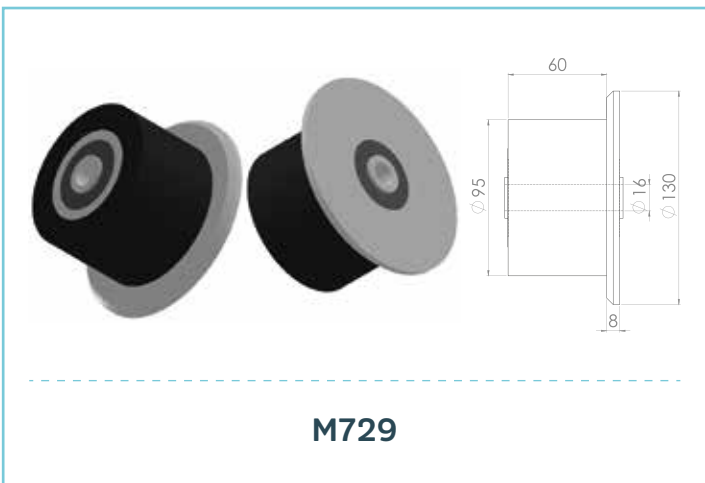

**M729**

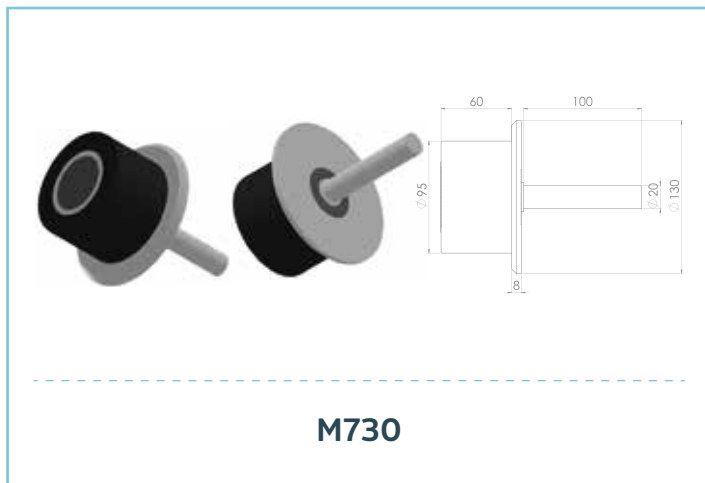

**M730**

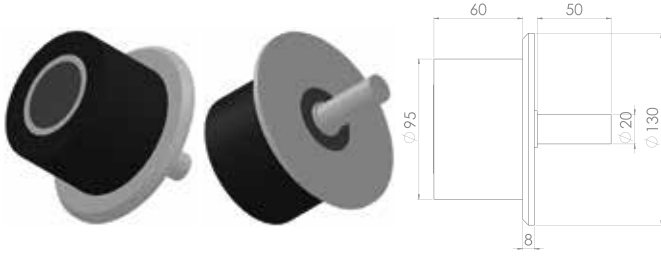

M731

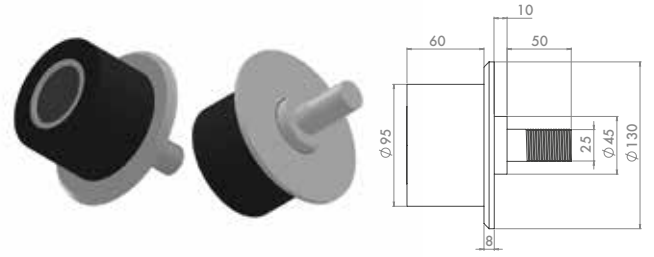

M732



M733



M734

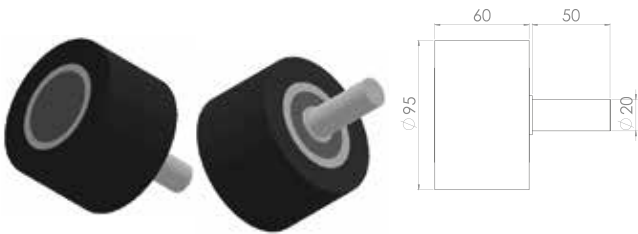

M735



M736



M737

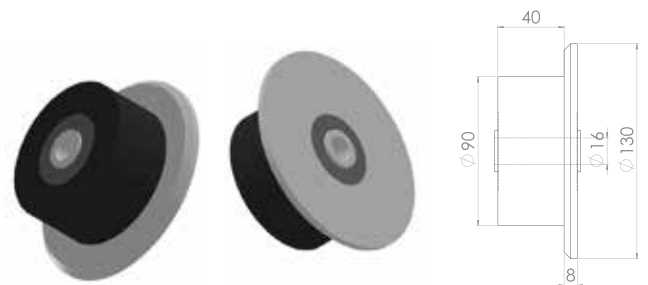

M738



M739



M740

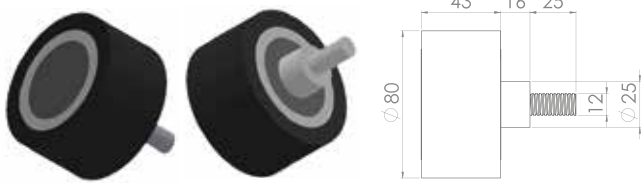

M741



M742

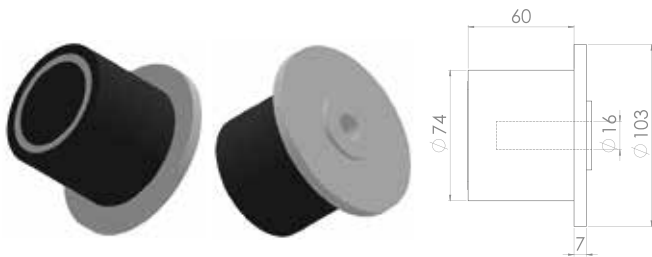

M743



M744



M753



M754

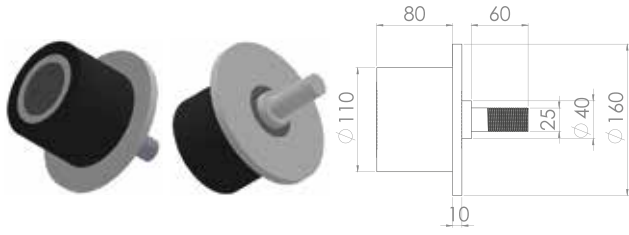

M755

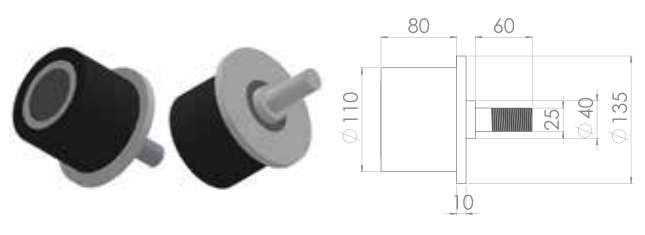

M756

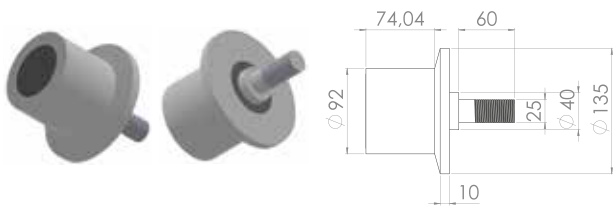

M757

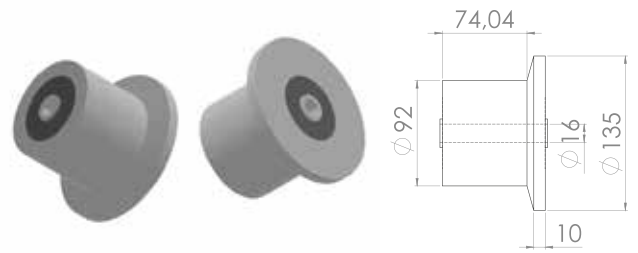

M758



M759



M760



M761

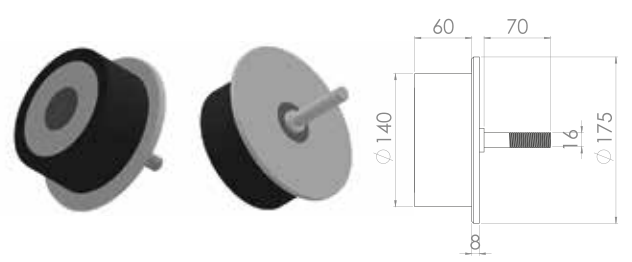

M762



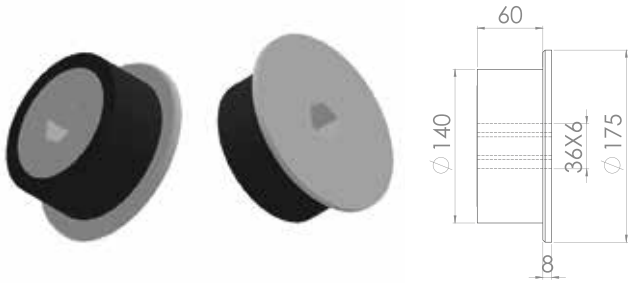

M763

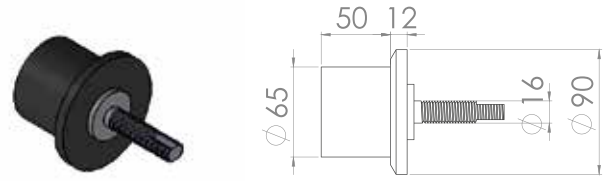

M764

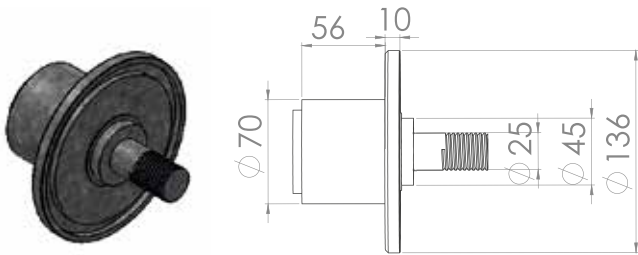

M765



M766

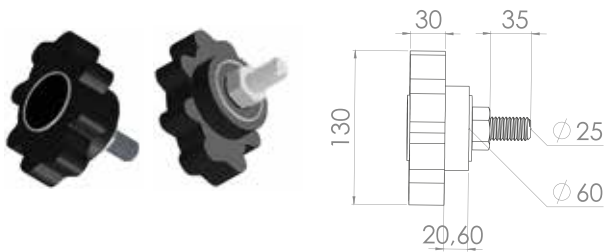

M767



M768

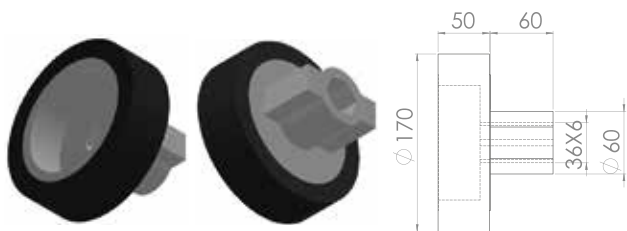

M769

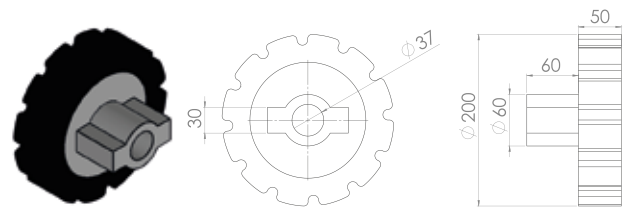

M770

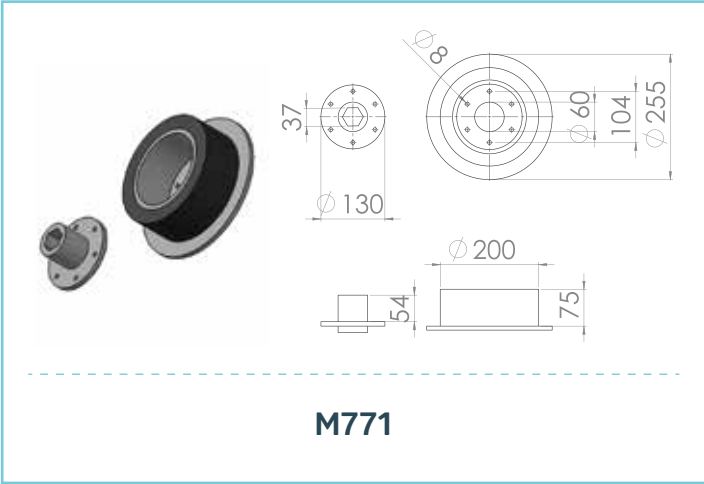

M771

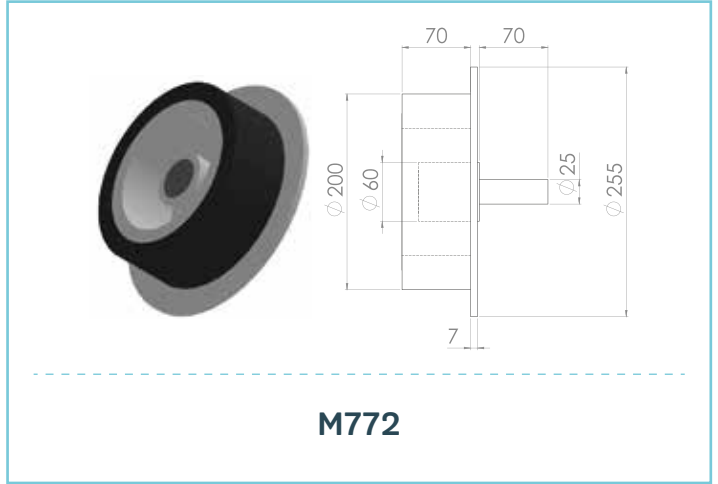

M772

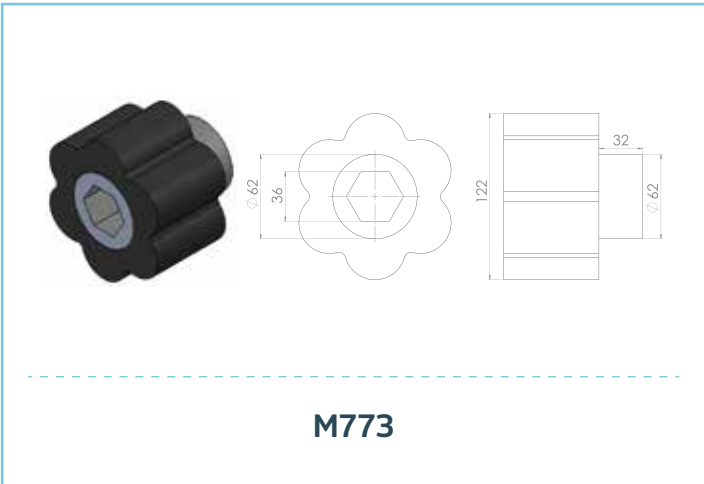

M773



M774



M775



M776

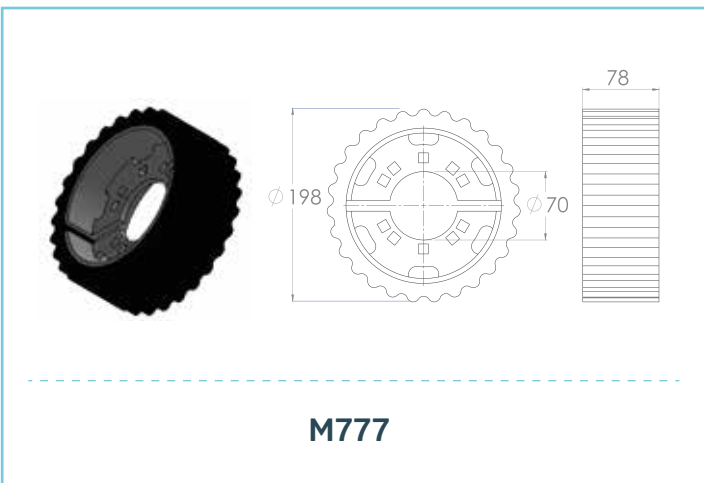

M777



M778

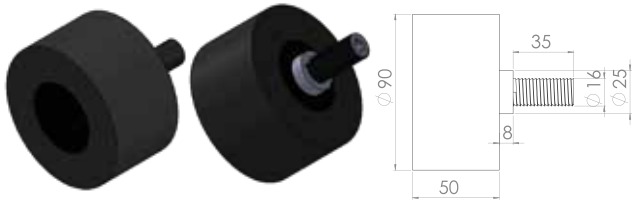

M779

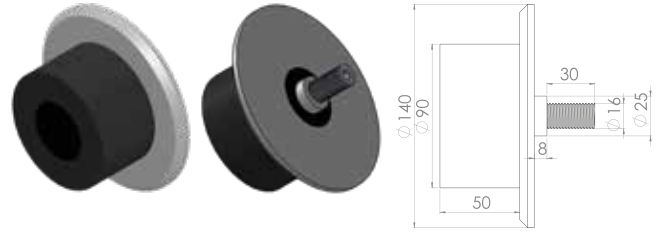

M780



M781



M782

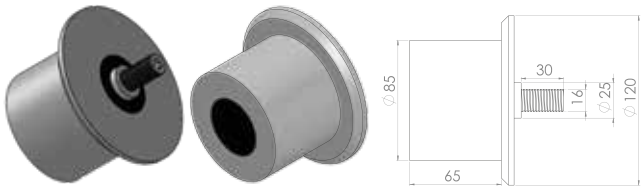

M783

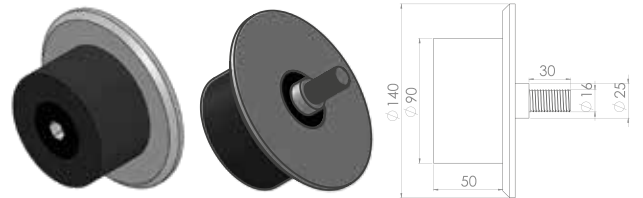

M784

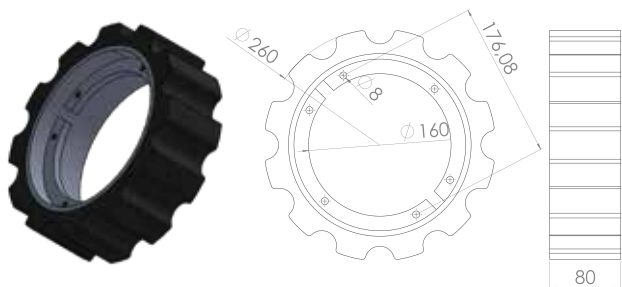

M785

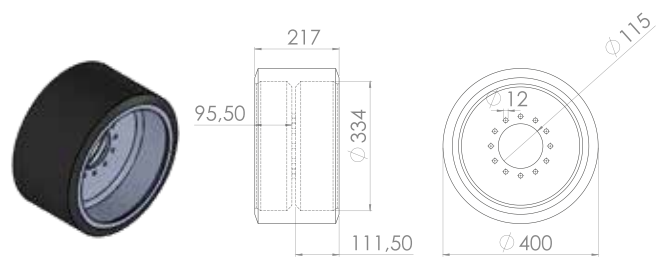

M786

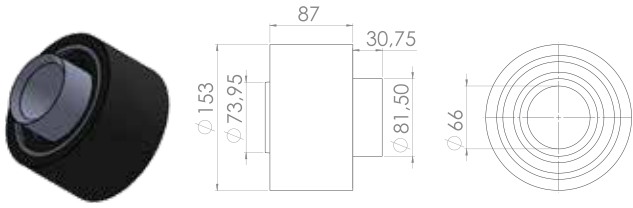

M787

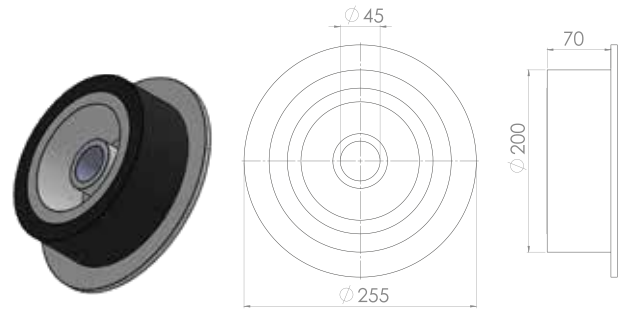

M788

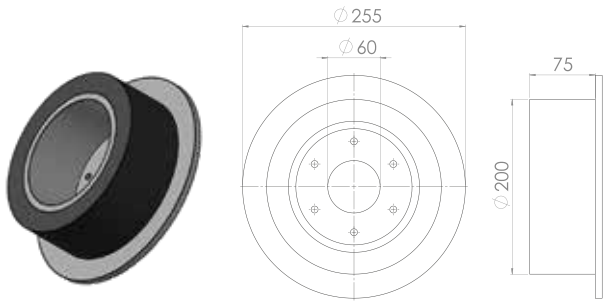

M789



M790



M791

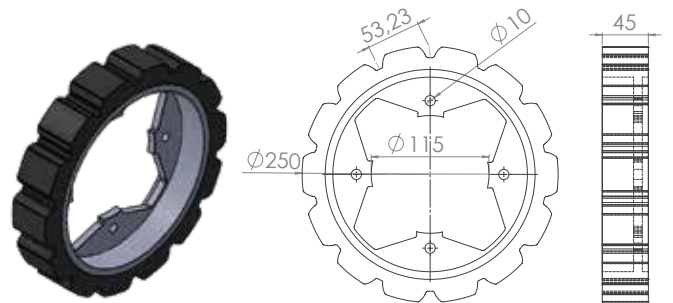

M792



M793

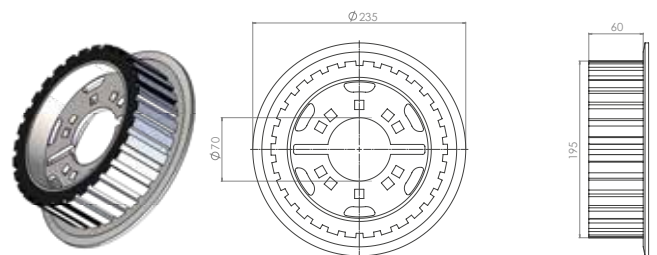

M794

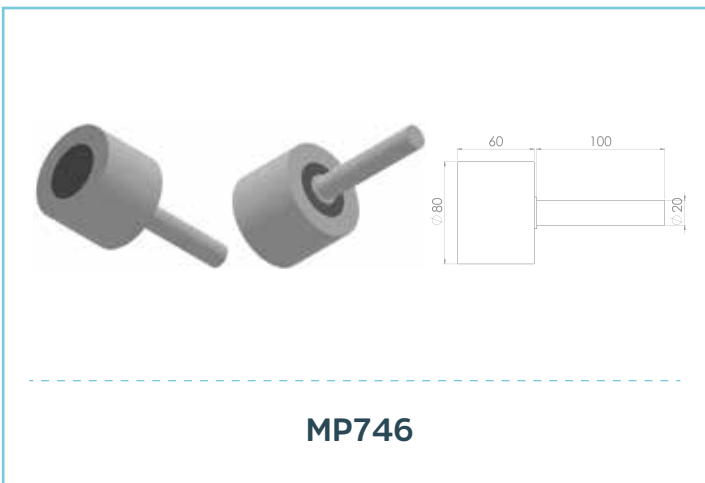
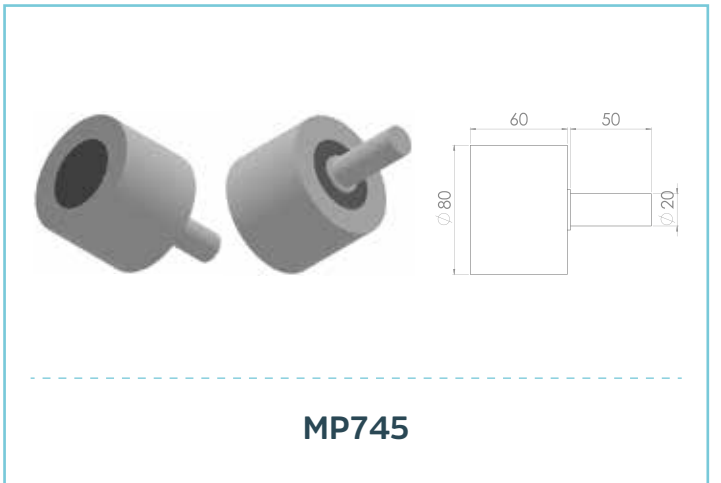
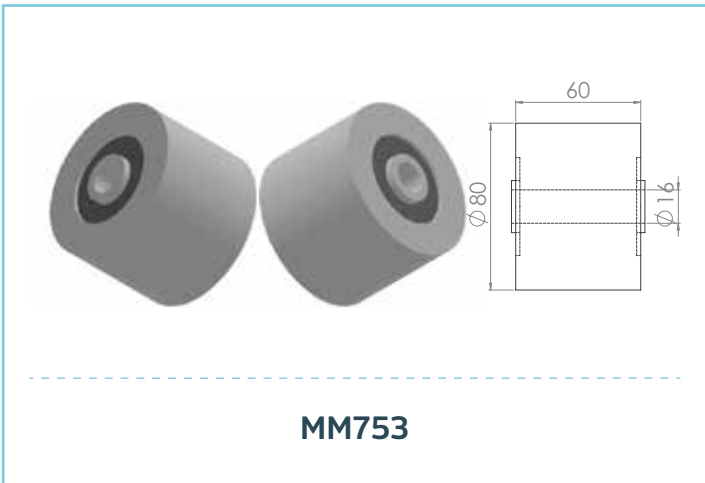
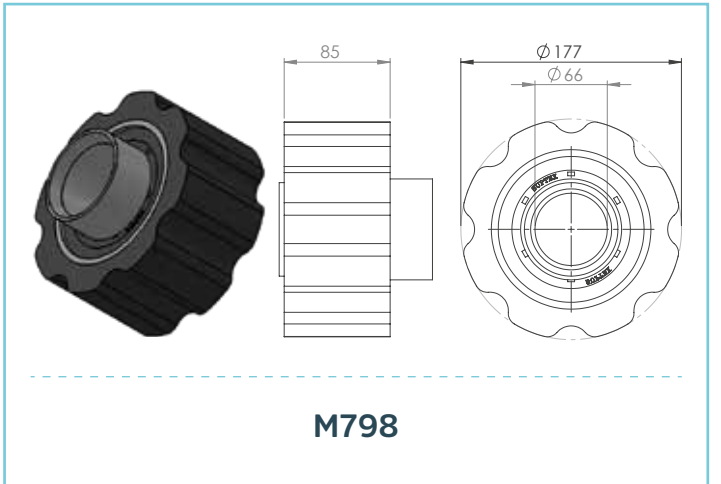
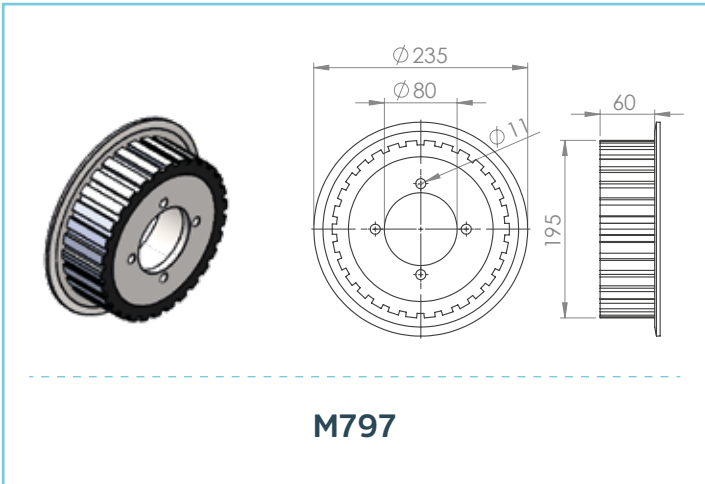
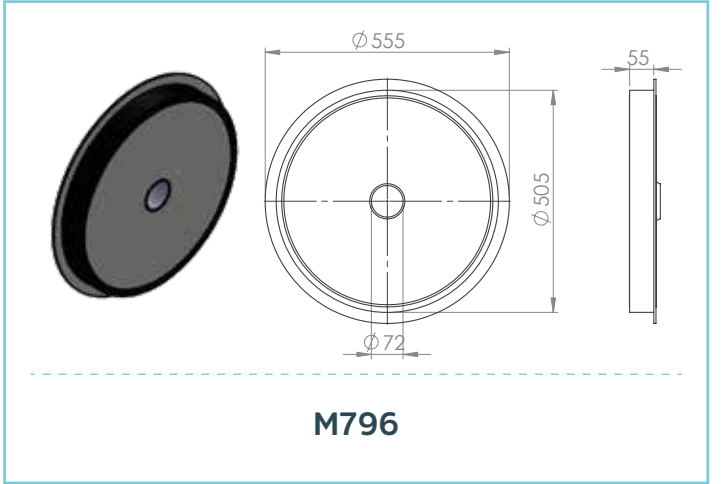

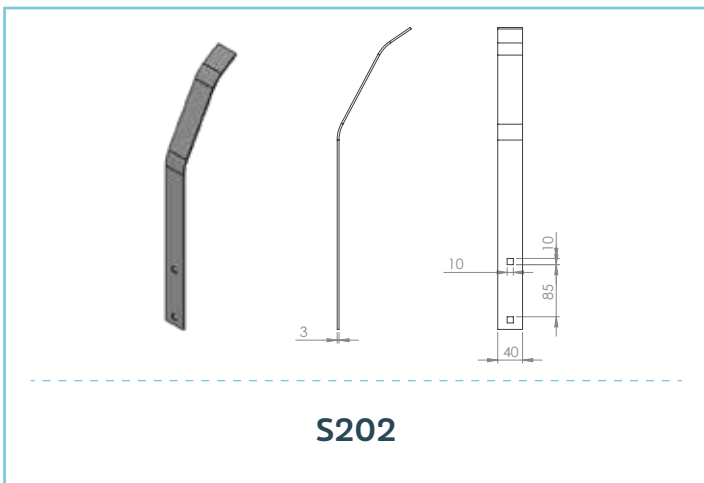
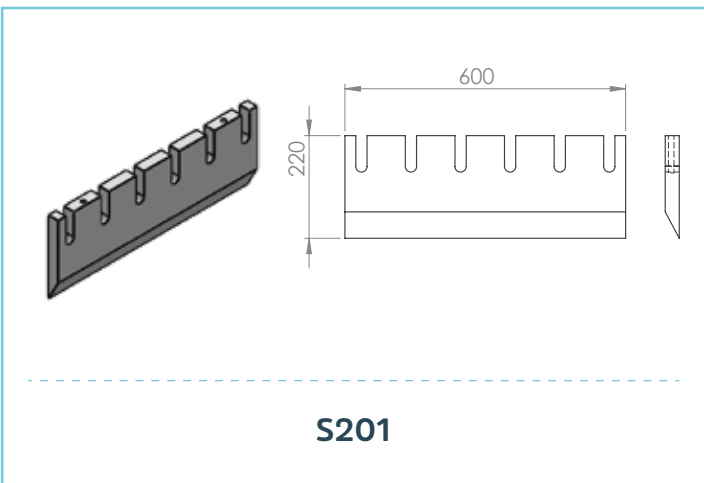
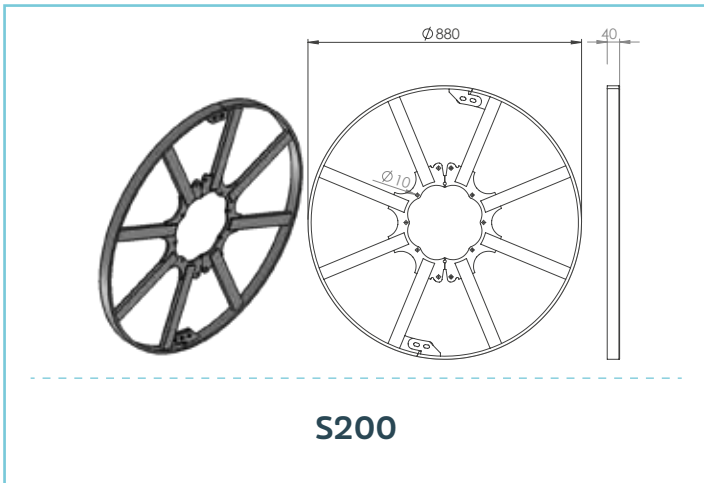
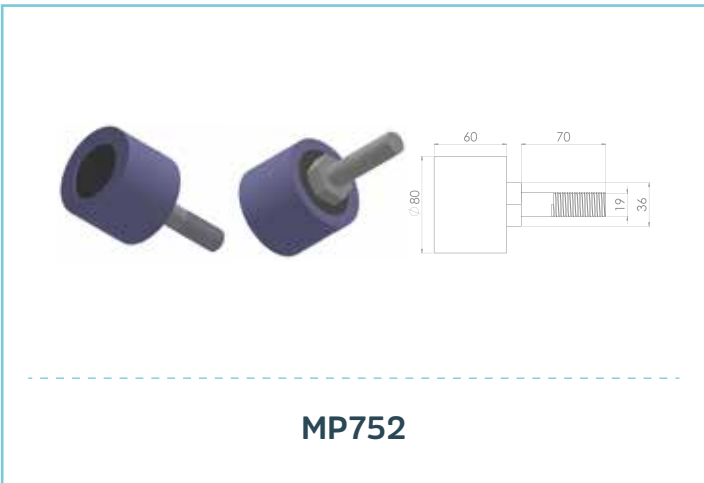
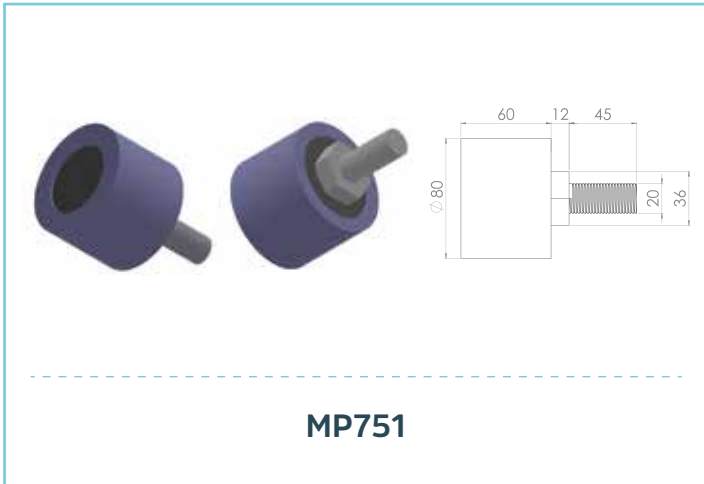
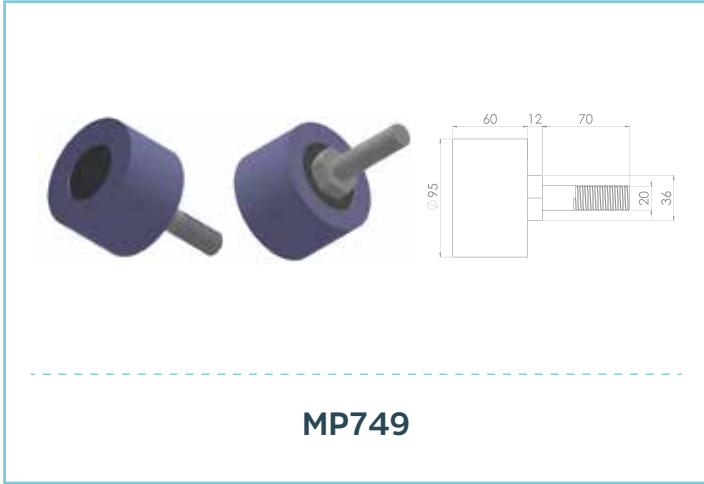
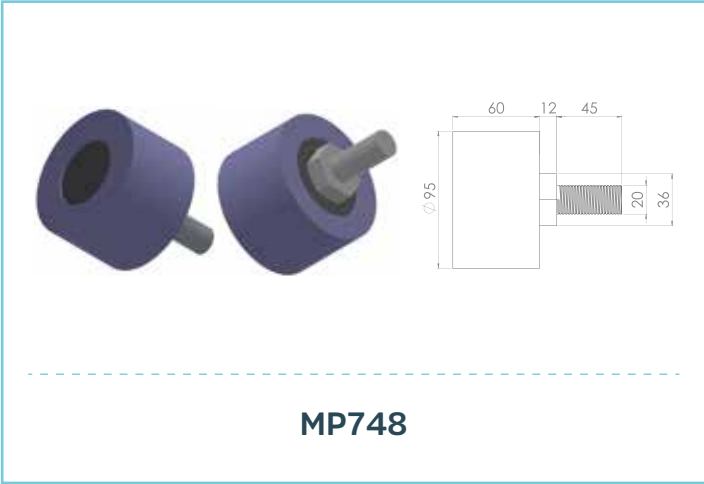

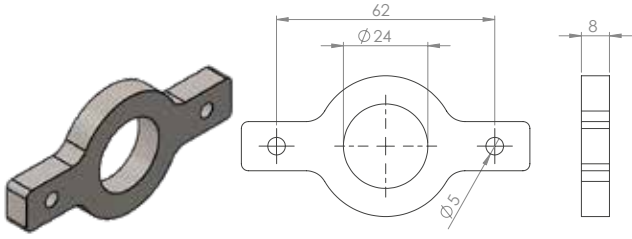

S203

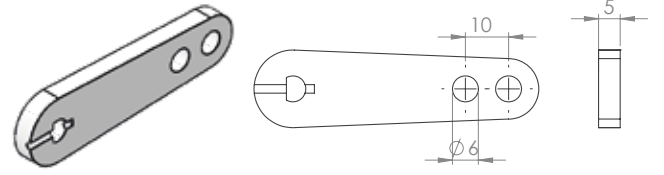

S204

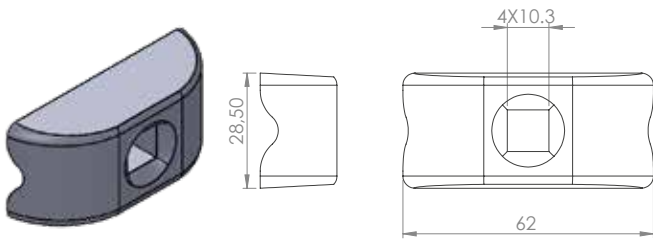

S205

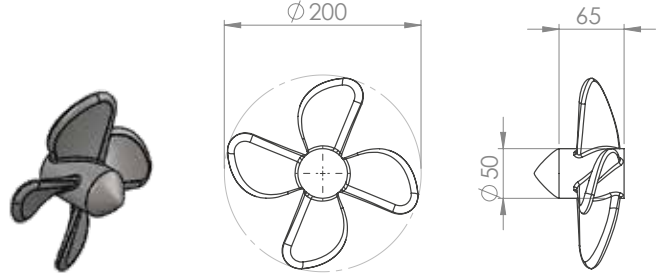

S206

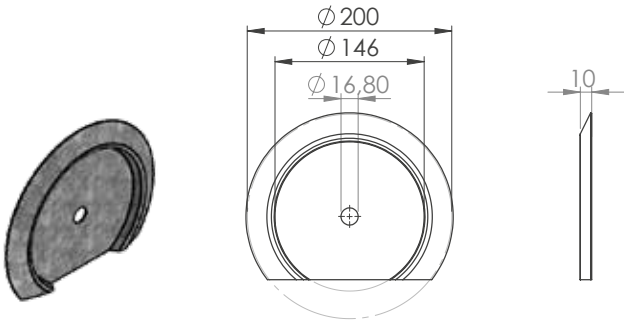

S207

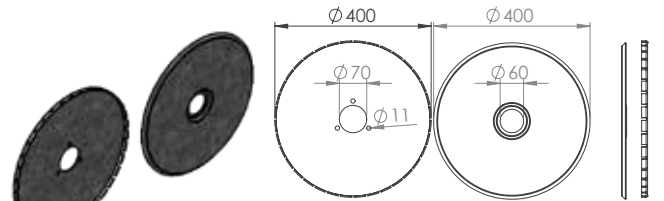

S208

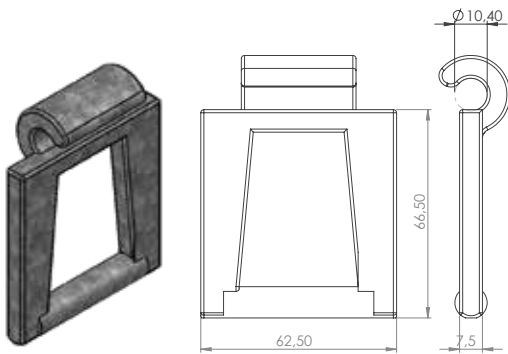

S209

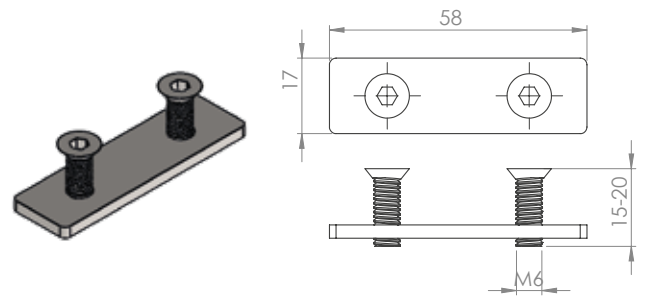

S210



## ÇUBUK KALINLIĞI (mm)

8
10
11
12
13

## A

20-32-50

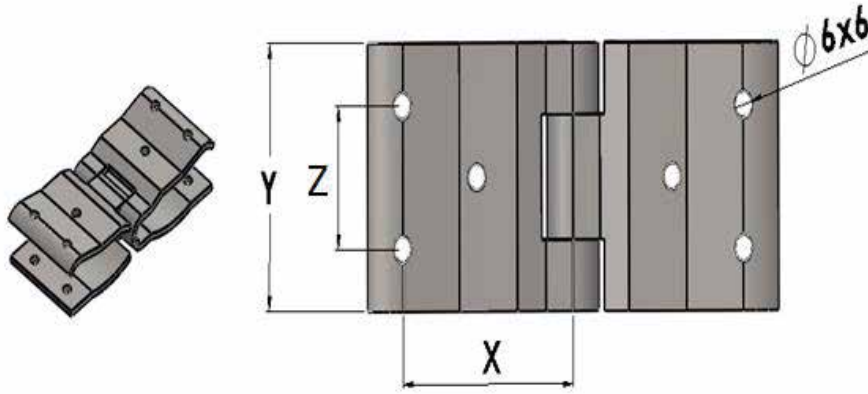

## ÖLÇÜLER - DIMENSIONS

X	X	Z
28	60	32
35	60	32
40	60	32
50	60	32
60	60	32
40	70	32
50	70	32
60	70	32
36	56	32
28	46	20
36	46	20

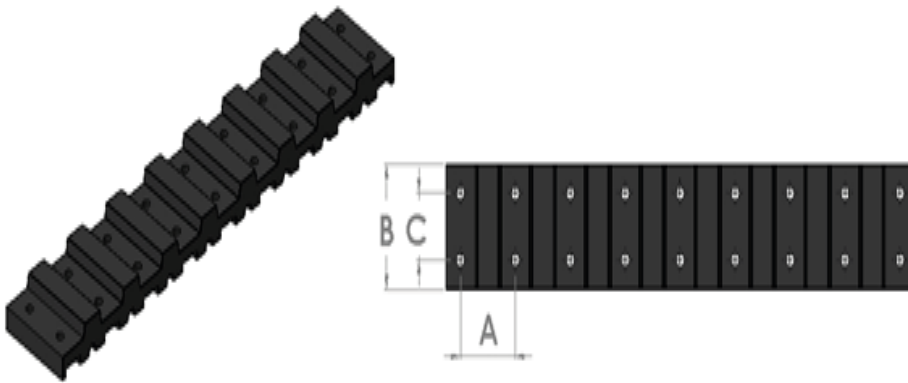

## ÖLÇÜLER - DIMENSIONS

A	B	C
28	60	32
32	60	32
35	60	32
40	60	32
50	60	32
60	60	32
40	70	32
50	70	32
60	70	32
85	50	25
28	52	20
32	52	20
50	35	-
85	100	25
45	120	50
50	120	50



## SINIFLANDIRMA MAKİNESİ

Sorting Machines



**Sınıflandırma makinesi ürün kalınlığına göre sınıflandırma işlemini yapan makinedir.**

**Sektör olarak pek çok kesime hitap eder. Sınıflandırma makinesi sınıflandırma kolaylığı ve işçiliği minimuma indirdiğinden dolayı tercih edilmektedir.**

*The sorting machine is the machine that sorts according to the thickness of the product.*

*As a sector it addresses many segments. The sorting machine is preferred because it minimizes the ease of sorting and craftsmanship.*

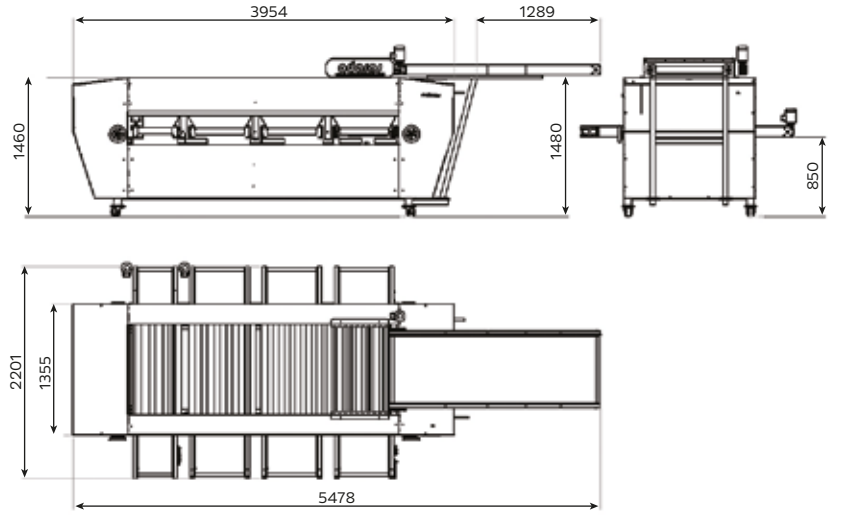

### GENEL ÖZELLİKLER

- 15mm-200mm sınıflandırma aralığı
- Ayarlanabilir sınıflandırma aralığı
- Ayarlanabilir sınıflandırma hızı
- Hem otomatik hem manuel, her iki yöne de çalışabilen dört adet konveyör
- Gıdaya uygunluk
- Kolay kurulum
- 304 kalite paslanmaz çelik gövde
- %100 yerli üretim

### GÜÇ GEREKSİNİMİ

- 5.5 Kw

### OPSİYONLAR:

- Ön yükleme konveyörü (0,75 Kw)
- Ana yükleme bunkerli konveyör (Konveyör ölçülerine göre güç gereksinimi değişiklik gösterebilir.)

### GENERAL FEATURES

- 15mm-200mm sorting range
- Adjustable sorting range
- Adjustable sorting speed
- Both automatic and manual, four conveyor can operate in both directions
- Food availability
- Easy setup
- 304 quality stainless steel
- 100% Domestic Production

### POWER REQUIREMENTS

- 5.5 Kw

### OPTIONS

- Front loading conveyor (0.75 Kw)
- Main loading bunker conveyor (according to conveyor dimensions, power requirement may change.)

## MİNİ SINIFLANDIRMA MAKİNESİ

Mini Sorting Machine



**Sınıflandırma makinesi ürün kalınlığına göre sınıflandırma işlemini yapan makinedir.**

**Sektör olarak pek çok kesime hitap eder. Sınıflandırma makinesi sınıflandırma kolaylığı ve işçiliği minimuma indirdiğinden dolayı tercih edilmektedir.**

*The sorting machine is the machine that sorts according to the thickness of the product.*

*As a sector it addresses many segments. The sorting machine is preferred because it minimizes the ease of sorting and craftsmanship.*

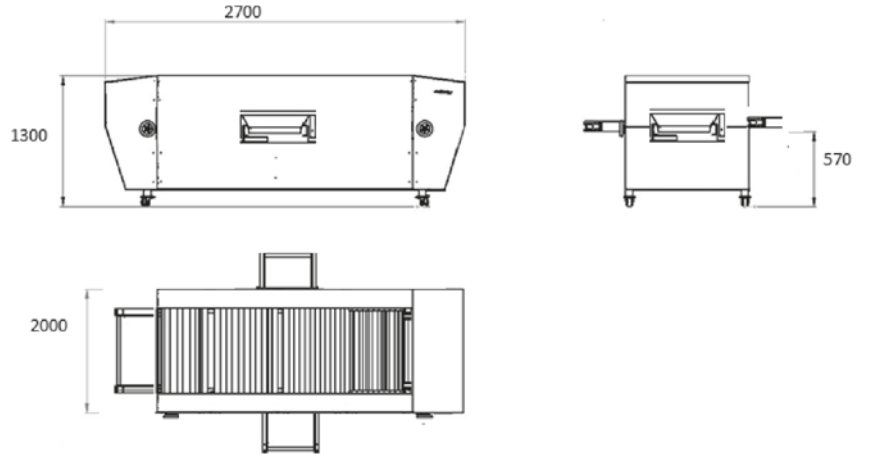

### GENEL ÖZELLİKLER

- 15mm-200mm sınıflandırma aralığı
- Ayarlanabilir sınıflandırma aralığı
- Ayarlanabilir sınıflandırma hızı
- Gıdaya uygunluk
- Kolay kurulum
- 3 sınıfa ayırır
- %100 yerli üretim

### GÜÇ GEREKSİNİMİ

- 4 Kw

### OPSİYONLAR:

- Ön yükleme konveyörü (0,75 Kw)
- Ana yükleme bunkerli konveyör (Konveyör ölçülerine göre güç gereksinimi değişiklik gösterebilir.)

### GENERAL FEATURES

- 15mm-200mm sorting range
- Adjustable sorting range
- Adjustable sorting speed
- Food availability
- Easy setup
- Divides into 3 classes
- 100% Domestic Production

### POWER REQUIREMENTS

- 5.5 Kw

### OPTIONS

- Front loading conveyor (0.75 Kw)
- Main loading bunker conveyor (according to conveyor dimensions, power requirement may change.)

## TAŞ AYIRMA MAKİNESİ

Stone Separating Machines



**Taş ayırma makinesi su ile çalışan bir makinedir. Sökümden gelen topraklı kök sebzelerini istiflenmeden önce taş, toprak ve istenmeyen otlardan ayırmaya yarar. Teknik resimdeki ölçüler büyük kapasiteli makinenin ölçüleridir. Küçük kapasiteli makinenin ölçüleri yıldızlı ölçülerdir.**

Stone separating machine is a machine that works with water. It is used to separate harvested grounded root vegetables from stone, soil and unwanted herbs before stacking.

The dimensions in the technical drawing are the dimensions of the large capacity machine. The dimensions of the small capacity machine are the following dimensions indicated by the symbol

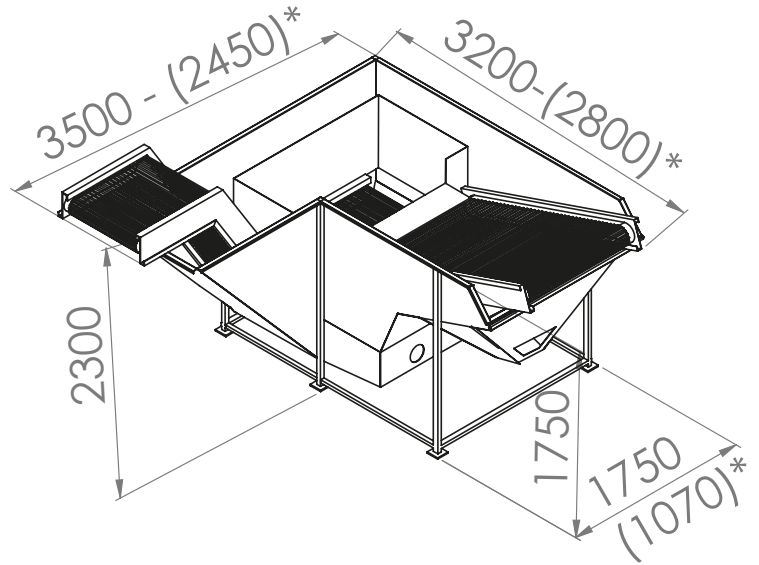

### GENEL ÖZELLİKLER

- Her iki yöne de çalışabilen konveyörler
- Ayarlanabilir konveyör hızı
- Bakım kolaylığı
- Kolay kurulum
- %100 yerli üretim

### GÜÇ GEREKSİNİMİ

- 12.5 kW büyük kapasiteli - 7 kW küçük kapasiteli

### OPSİYONLAR:

- Ot temizleme sistemi (2.25kW)
- Ana yükleme bunkerli konveyör (Konveyör ölçülerine göre güç gereksinimi değişiklik gösterebilir.)

### GENERAL FEATURES

- Conveyors that can operate in both directions
- Adjustable conveyor speed
- Ease of maintenance
- Easy setup
- 100% Domestic Production

### POWER REQUIREMENTS

- 12.5 kW large capacity - 7kW small capacity

### OPTIONS

- Unwanted leaf cleaning system ( 2.25kW )
- Main loading bunker conveyor (Power requirement may vary depending on conveyor size.)

## SAP VE KÖK KESME MAKİNESİ

Neck And Root Cutting Machine



*Sap ve kök kesme makinası, ürünlerin sap ve köklerini keser. Bu işlem uygulanırken ürünlere basınç uygulamadığından zararsız gerçekleşir. Genel kullanım alanı soğan, sarımsak ve haşhaş olduğu gibi daha da genişleyebilir.*

*Neck and root cutting machine cuts the necks and roots of the products. This process is harmless because it does not apply pressure to the products. The general use area can be further expanded as onions and garlic.*

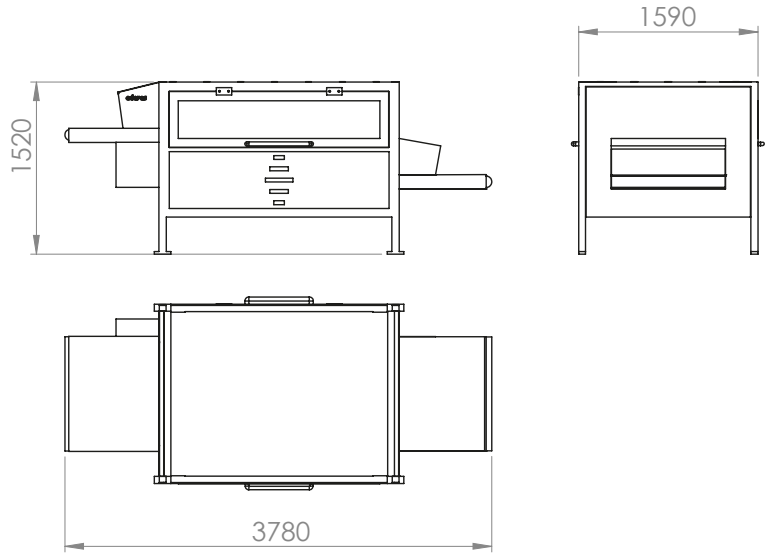

### GENEL ÖZELLİKLER

- Ayarlanabilir kesme hızı
- Gıdaya uygunluk
- Kolay kurlum
- %100 yerli üretim

### GÜÇ GEREKSİNİMİ

- 5,75 kW

### OPSİYONLAR:

- Ana yükleme bunkerli konveyör (Konveyör ölçülerine göre güç gereksinimi değişiklik gösterebilir.)

### GENERAL FEATURES

- Adjustable cutting speed
- Food availability
- Easy board
- 100% Domestic Production

### POWER REQUIREMENTS

- 5,75 kW

### OPTIONS

- Main loading bunker conveyor (according to conveyor dimensions, power requirement may change.)

## BUNKERLİ YÜKLEME KONVEYÖRÜ

Bucket Loading Conveyor



Ürün transferinde büyük kolaylık sağlar. Konveyörün tasarımı sayesinde ürün taşınırken aynı zamanda elek görevi yaparak temizlenmesini sağlar. İstek doğrultusunda ebatlandırma yapılabilir.

Through conveyor desing provides great convenience in product transfer. While the product is being transported, it also enables cleaning by performing sieve operation.

## ÇAVUŞ TİPİ KONVEYÖR BANT

Chevron Conveyor Belts

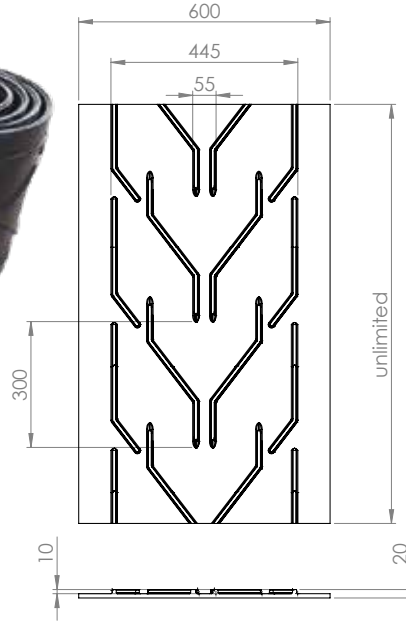

Aşındırıcı ve iri taneli malzemenin taşınmasında kullanılır. Darbelere karşı dayanıklıdır.

Sektör olarak pek çok kesime hitap eder. İstek doğrultusunda ebatlandırma yapılabilir, şasei şekilde de imalat yapılabilir.

It is used for the transport of abrasive and coarse material. Impact resistant.

As a sector, it addresses many sectors. Dimensioning according to request, can also be manufactured in a mechanical line.

## KİPRİ ŞASE

Cleaner



Ürünü temizleme işlemi yapar. Ürünün ot, çöp, çakıl, kum ve toprak gibi yabancı maddeleri arındırır.

İstek doğrultusunda ebatlandırma yapılabilir.

Performs cleaning of the product. The product purifies foreign materials such as grass, rubbish, gravel, sand and soil. Sizing can be done on request.

## PALET DÖNÜŞÜM SİSTEMİ

Conversion Track System



**AKOTOM Palet Dönüşüm Sistemleri, yumuşak zemin koşullarına sahip alanlara daha iyi tutunma için makinenizin hareketliliğini artırır. Toprağın sıkışmasını azaltır. Tarla hazırlığı, ekim, hasat ve nakliye kadar çalışma maliyetlerini düşürürken işinizi en üst seviyeye çıkarmanıza yardımcı olur.**

**Geniş ayak izi sayesinde zemin sıkışmasını azaltır, saha hasarını ve saha üzerindeki dengesizliği en aza indirir.**

**İşinizin genel verimliliğini ve kalitesini en üst seviyeye çıkarır.**

**Farklı makine modelleri ve uygulamalarında kullanılabilir.**

### GENEL ÖZELLİKLER

- Geniş basma yüzeyi
- Kolay kurulum
- Paslanmaz çelik gövde
- %100 yerli üretim

## PALET DÖNÜŞÜM SİSTEMİ

Conversion Track System



*AKOTOM Conversion Track Systems, increases the mobility of your machine for better grip on areas with soft ground conditions. Reduces soil squeezing. Helps you to maximize your work while reducing operating costs, from field preparation, planting, harvesting and transportation. Reduces ground clamping due to large footprint, minimizes field damage and field imbalance. Maximizes the overall efficiency and quality of your business. Can be used in different machine models and applications.*

### GENERAL FEATURES

- Wide pressure surface
- Easy setup
- Stainless steel body
- 100% Domestic Production



# akotom®

**Konveyör Bant**  
Crop Conveyor Belts

adanas bir akotom markasıdır.

F. Çakmak Mh. Büsan Org. San. Bölğ.  
10665 Sk. No:2/C Karatay/KONYA  
Tel: 0332 251 11 75  
Faks: 0332 251 11 74  
info@akotom.com  
www.akotom.com

**YERLİ  
ÜRETİM**

